

ideas



DECOUPAGE



WORK WITH RESIN



USE GOLD LEAF



KINTSUGI



PHOTO TRANSFERS



STRING ART



PAPIER-MÂCHÉ



MOSAIC MAKES

R55,00 (R6.75 VAT INCL.)
Other countries R48.25 (TAX EXCL.)



OUR MOST POPULAR PROJECTS WITH STEP-BY-STEP INSTRUCTIONS



You have your **brush**,
you have your **colours**,
now paint your **paradise!**



ART & CRAFT MATERIALS

Creativity is not just a hobby... it's a way of life.

Artistic mastermind or inventive soul, **PNA** will inspire your imagination and stimulate your creativity with a wide range of **Art & Craft materials**, guaranteed to assist in creating your very own masterpiece.

Make the most of **PNA's** diverse range of products...

RANGE OF ART & CRAFT MATERIALS

Artist pencils & pads | Balsa wood | Brushes | Calligraphy | Canvases
Charcoal | Chipboard embellishments | Clays & tools | Clock hands
Clock mechanism | Copic markers | Corrugated board
Craft embellishments | Craft knives | Craft paints & mediums
Craft punches | Cuttlebug (embossing folder & die cuts
Decoupage | Dowel sticks | Easels | Fabric paint & patterns | Feathers
Foam board | Glitter | Glue guns | Haberdashery items (ribbons, buttons) | Heat guns | Ink pads & rubber stamps | Kids craft & kits
Lino | Mirror embellishments | Mosaics, inserts & tools | Origami
Paints & accessories (oil paint, acrylic paint, gouache) | Paint by number | Palettes & palette knives | Paper trimmers | Paper varieties (scrapbook paper, handmade paper, embossed paper)
Pastels | Pergamano | Pewter & accessories | Plaster of paris
Plastic moulds | Polystyrene items | Polystyrene cutters | Quilling
Resin embellishments | Rubber rollers | Scrapbook albums
Sealing wax & stamps | Serviettes | Soap making | Sponge rollers
Stencils | Touch markers | Felt squares | Washi tape | Wooden blanks



Colour your World...

* Available at selected PNA stores nationwide



www.pna.co.za

Stationery | Art & Craft Materials | Educational Books | Gifts



ideas

EDITOR Terena le Roux
Email ideased@media24.com

CREATIVE DIRECTOR Dala Watts
MANAGING EDITOR Marweya Smal

Cape Town Office Manager Natalie Herman
18th Floor Absa Centre,
4 Adderley Street
Cape Town 8001
Box 1802, Cape Town 8000

Reception and General Queries 021 408 3042
Johannesburg Office Media Park, 69 Kingsway
Auckland Park, Johannesburg

Syndication Manager Lucille van der Berg
021 408 3038

LAYOUT Dala Watts
CHIEF COPY EDITOR Diana Procter

Styling Carin Smith, Dala Watts, Lynnae Endersby
Craft and DIY Lizel Cloete, Ciskia Hanekom, Marlize Lotz
Photographer Ed O'Riley, Francois Oberholster, Christo Lötter
Digital Lizette Stulting

Office Assistant and Driver Fuad Fritz
Retoucher Katherine Clulow

WOMEN'S INTEREST DIVISION
Publisher Marina Smith

Advertising sales
Head: Advertising Sales (CPT) Sarah Curtis-Bowles 084 444 8880

Circulation Manager Adele Minnaar 011 217 3263
Product Manager Wikus Esterhuysen

CEO: Media24 Esmaré Weideman
CEO: Media24 Lifestyle Charlene Beukes
CFO: Media 24 Lifestyle Raj Lalbahadur

MEDIA24

Published by Media24, a division of Naspers. 40 Heerengracht, Cape Town 8001.

where printing is personal

ON THE DOT

Copyright Media24. All rights reserved. No part of this publication may be reproduced, stored in a retrieval system or transmitted, in any form or by any means, electronic or mechanical, without the prior permission in writing from the publisher. While reasonable precautions have been taken to ensure the accuracy of advice and information given to readers, the editor, proprietors and publishers cannot accept responsibility for any damages or inconvenience that may arise therefrom. The editorial staff have the right to make alterations to any material submitted, and cannot be held responsible for the loss of or damage to any material submitted for publication. All prices quoted were correct at the time of going to press, and may vary from shop to shop.



9



37



69



13



47



77



17



54



79



23



66



86

6 FROM THE EDITOR

8 KINTSUGI

Fix broken ceramics with a modern take on the Japanese art of 'golden joinery'

12 MOSAIC

We show you a few ways to bring this therapeutic handcraft into your home.

16 GILDING

Once you have learned how to use metal leaf, nothing needs to look dull.

22 LINO PRINTING

Make your own mark with lino stamps.

32 PAPIER-MÂCHÉ

We give you step-by-step instructions and some lovely projects to inspire you.

42 DECOUPAGE

The creative possibilities are endless!

52 PHOTO TRANSFER

Transfer photos onto fabric, glass or tiles.

60 RESIN

With resin, there's no limit to the things you can make for your home.

68 AIR-DRY CLAY

Interesting textures and shapes are easy to make with this medium.

74 STRING ART

Craft modern 'artworks' for your walls.

78 MAKE PAPER

Everything you need to know to make your own beautiful paper.

84 SCREEN PRINTING

Print your designs on fabric, paper, wood and cork. We show you how.



FROM THE EDITOR



 **Look out for this flower symbol – all the products that are marked with it are available from selected PNA branches nationwide.**

The first craft items that I remember are oval-shaped decoupage ‘pictures’ with a motif from a serviette (usually a flower or an animal) in the middle and a piece of cord around the edge to finish them off. They were on sale at every bazaar, but I preferred to keep my money for the pancake stand. The decoupage creations weren’t quite enough to inspire me to buy them or to start crafting.

The result was that when I joined *Ideas* years later I knew the difference between lovely and ugly, but I wouldn’t have been able to tell you anything about the difference between glue sticks and modge podge. As the craft pages landed on my desk month after month, I simply walked over to the craft room to check that everything made sense. And so I learned, year on year and literally step by step, about this wonderful creative playground where you can not only beautify your house but also make a living – and let’s not forget its therapeutic value!

A new world in which everything is possible opened up for me. If you can’t find the cushion that you’re looking for, you can do a photo transfer onto a plain one, and if your chairs start to bore you, you can decoupage them. Modern crafts differ enormously from those that most of us grew up with, and here in the office it’s better to keep quiet than admit that you don’t actually know how to use a glue gun or work with gold leaf.

This issue is just the thing if you would like to join in the conversation and the crafting. We went through old letters and inquiries from our readers and one by one sought out the projects that brought us the most response. Now they are all presented here in one lovely collection, with everything that you need and step-by-step photos to make them easier for you to do. But be warned – once you start, you won’t be able to stop.

Enjoy!

Terena





We all have that
one pen
that makes our handwriting look
beautiful!



STATIONERY

There is more to writing than simply putting pen to paper and at **PNA** we know this better than most.

Pop into your local **PNA**, where you will find an extensive range of stationery products and writing materials with which to work, learn and play.



Colour your World...



www.pna.co.za

Stationery | Art & Craft Materials | Educational Books | Gifts

KINTSUGI

KINTSUGI ('GOLDEN JOINERY') IS THE ANCIENT JAPANESE ART OF FIXING BROKEN CERAMICS WITH A MIX OF LACQUER VARNISH AND GOLD OR SILVER POWDER. WE'VE ADAPTED THE TECHNIQUE SLIGHTLY.

You will need

broken ceramic item

FOR THE GLUE PASTE

gold or silver powder OR

✿ powder paint in the colour of your choice

epoxy glue

disposable plastic container

✿ ice-cream sticks

NOTE Kintsugi is traditionally done with gold or silver, but for a modern version you can experiment with other colours, as we have done on page 10.





Make Kintsugi glue

1 Mix the two parts of the epoxy glue in the correct proportions (see the manufacturer's instructions) in the plastic container. Make sure that you mix enough glue to fix all the pieces.

2 Use an ice-cream stick to add a small amount of gold or silver powder or powder paint to the glue.

3 Mix the glue and powder together thoroughly to make a glue paste.

FIX CERAMICS WITH FLAIR

You will need

plate or other ceramic item that you want to mend

🌸 powder paint in the colour of your choice

epoxy glue

🌸 ice-cream sticks



1 Arrange the broken pieces according to how they need to be reassembled. We decided to first glue the two smaller pieces onto the two larger ones before we joined the resulting two halves of the plate.



2 Squeeze the two parts of the epoxy glue in the correct proportions (see the manufacturer's instructions) into a disposable plastic container such as an old lid – make sure there is enough glue for the repair work.



3 Use an ice-cream stick to add a small amount of powder paint to the glue and mix it in thoroughly to make a coloured paste.

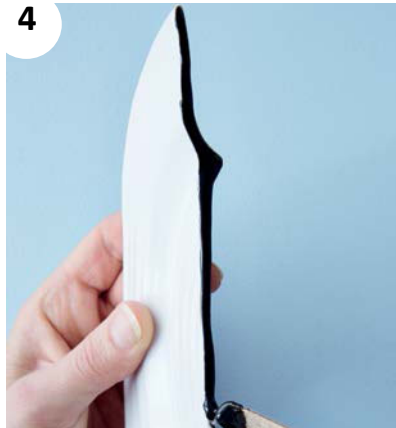

4 Apply the glue paste to the broken edge of the first plate piece. You will need to work quickly, before the glue sets.



5 Press the second piece onto the first piece and hold together firmly until the glue bonds. Do not wipe away the glue that seeps from the joint. **TIP** Clamp the pieces together or hold them in place with Prestik until they have bonded.

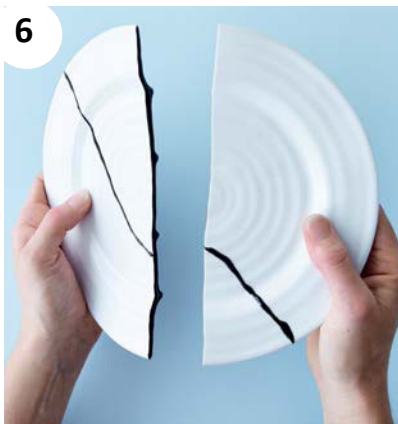

6 Repeat with the next two pieces and then apply glue paste to the edge of one of the large repaired pieces.



7 Press the two large pieces together and leave to set.



NOTE

You will be able to wash the plate by hand afterwards, but not in the dishwasher.

‘The art of Kintsugi is understanding
that the piece is more beautiful
for having been broken’



MOSAIC

MOSAIC IS ONE OF THE OLDEST AND MOST THERAPEUTIC HANDCRAFTS AROUND. HERE ARE A FEW WAYS TO BRING IT INTO YOUR HOME.

You will need

- 🌸 tiles or broken glass or plate fragments
- 🌸 tile cutters
- 🌸 tile glue
- 🌸 grout
- 🌸 ice-cream stick
- 🌸 sponge



WHAT IS MOSAIC?

Mosaic is an age-old art form that uses small pieces of glass, porcelain, ceramic, stone, and so on, to create a pattern. You can buy sheets of square mosaic tiles in a variety of colours and sizes (these are called tesserae), or you can cut your own tiles with random shapes. The tiles are glued to the item before the spaces are filled with grout. The drying time depends on how warm your work area is.

OVERSIZED LETTER

This is a very easy project, even if you have not done mosaic before. Use a pretty old plate that is chipped or cracked and a letter cut from Supawood. Turn to page 14 for the basic method.



1

Use a tile cutter to cut a pretty side plate into pieces. Arrange the pieces in the correct sequence, like a puzzle, on a square cut from Supawood.

2

Use a tile glue like Tylon Superflex to glue the pieces onto the pot stand – an ice-cream stick works well to apply adhesive to the back of each piece.

3

Cut up a matching wall tile for the background and place the pieces around the plate. Use the tile corners and edge pieces for the corners and edges of the pot stand.

4

Continue placing the pieces until the background is complete then glue the tiles in place as before. Leave to dry.

5

Mix tile grout in a plastic container, adding a little bit of water at a time until the mixture resembles the consistency of toothpaste.

6

Use a clean ice-cream stick to spread a thick layer of tile grout over the entire surface of the pot stand.

7

Use your fingers to work the grout in between the mosaic pieces and then wipe off any excess with your hands. Make sure you don't remove the grout from between the pieces.

8

Clean further with a damp sponge. Leave the grout to set a bit and then wipe again with a clean sponge. Leave to dry and then repeat until the pot stand is properly clean.

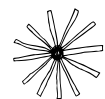

Notes

- If you're working on wood, you can use wood glue or tile glue to stick the pieces in place. If you're working on a ceramic or glass surface, it is best to use tile glue.
- You can make grout in the colour of your choice by adding a little PVA paint to your white grout mixture. We mixed oatmeal-coloured paint and white grout.
- Instead of using a tile cutter, you could also break the plate or tile into pieces, but this makes it more likely to shatter. A tile cutter gives you more control so you can cut the pieces into the exact size and shape that you require.
- If you would like to keep the original pattern or shape of the item in your mosaic (as with our plate), it helps to take a digital photo of it to refer to later.
- For a perfect fit, use a non-permanent marker to mark where the tile should be cut. This helps for the background, and for corners or strange shapes.

MOSAIC POT STAND



GILDING

ONCE YOU HAVE LEARNED HOW TO USE METAL LEAF,
NOTHING IN YOUR HOUSE NEEDS TO LOOK DULL OR 'ORDINARY'.

You will need

item to gild

✿ metal leaf

water-based gilding size OR

✿ spray glue

✿ good-quality soft paintbrushes (that
won't shed their bristles)

✿ sponge brush

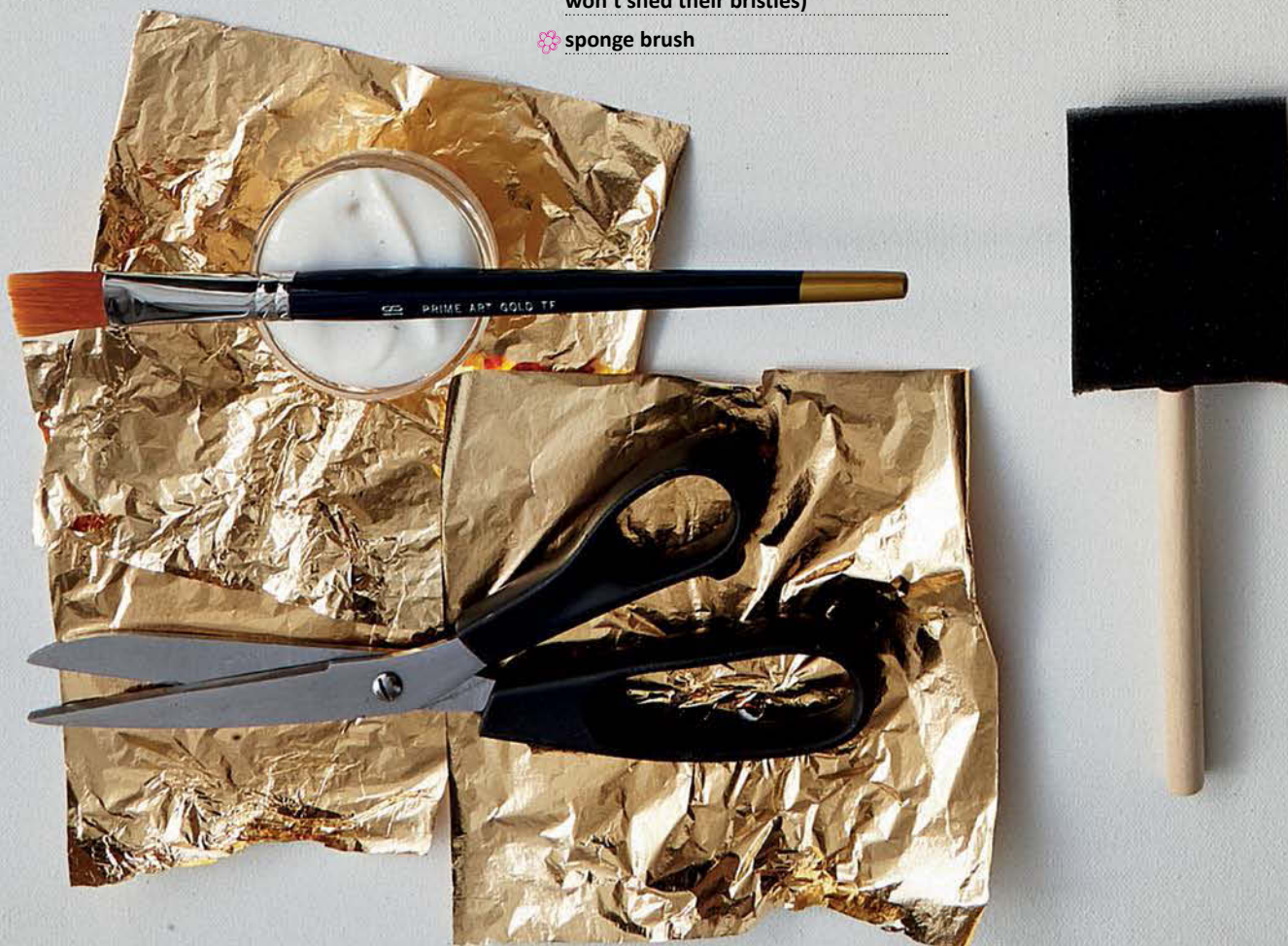

WHAT IS METAL LEAF?

Metal leaf is an imitation metal alloy that is rolled very thin and is sold in booklets or sheets. It is available in gold, silver and copper. You apply it with a special type of glue, called metal leaf adhesive or 'size', onto anything from wood to metal. The technique is sometimes called gilding.



TRIPOD STOOL

An everyday tripod stool undergoes a stylish makeover with a coat or two of black enamel paint and some gold leaf. After we had painted our stool and the paint had dried, we put masking tape low down on two of the legs and covered the feet with gold leaf so it looks as if they were dipped in gold.

COPPER TABLE

You can transform almost any décor item or piece of furniture with metal leaf. We gave a wooden table a makeover with copper leaf, but you could use an object made of metal, plastic or glass.

You will need

table or other piece of furniture

🌸 copper leaf

size

copper powder

🌸 soft, flat artist's paintbrush for the size

🌸 soft, wide paintbrush for smoothing

🌸 soft, small brush for copper powder

🌸 sponge paintbrush

universal undercoat

enamel paint

🌸 varnish

🌸 paintbrushes and sponge rollers



1



Clean the table, then paint it with universal undercoat and leave it to dry overnight. Apply two coats of enamel paint, leaving the first one to dry before painting the next.

NOTE You can use any colour enamel paint – it won't make a difference to the appearance of the copper leaf.

2



Use a flat artist's paintbrush to apply a thin, even coat of size to a corner area of the table. Leave to dry for 20 minutes or until it feels tacky.

TIP Use your knuckles to check if it is tacky, not your fingertips, to avoid leaving marks that will be visible through the copper leaf.

3



Use a sponge paintbrush to place a sheet of copper leaf on the size. Work with care because once the copper leaf has touched the size you can't reposition it.



4

Smooth out the copper leaf with a soft, wide paintbrush.

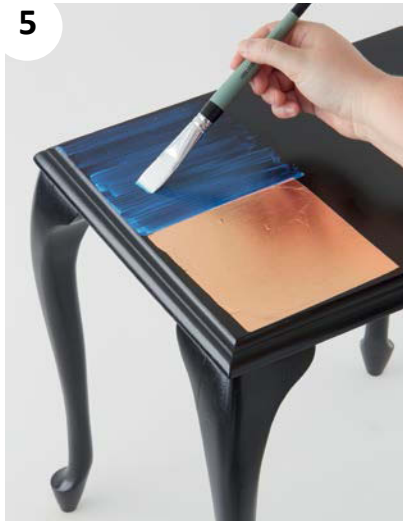

5

Paint size over the next section and repeat the process. Let the sheets of copper leaf overlap slightly.



6

Complete the rest of the table top in the same way. Carefully wipe off any loose bits of copper leaf as you work.



7

Cover the edges of the table top and the top half of each table leg with copper leaf, filling in any gaps with copper powder as you go along.



8

For the bottom half of the legs, we turned the table upside down onto a soft towel before applying the size. Cut the copper leaf sheets into smaller pieces while you wait for the size to become tacky. Repeat the process as before until all the legs are completely covered in copper leaf.



9

Paint the table with a suitable varnish to seal and protect the copper leaf. We used Plascon Paint Effects Glazecoat Gloss Varnish.



Preparation of wood

You can apply metal leaf directly onto wood, but make sure the item is free of grease and dust, and is dry. If you want to paint it first, you will need to sand the wood lightly and wipe it down with a damp cloth to remove the dust. Paint with a universal undercoat and leave to dry overnight before painting it in the colour of your choice.

TEA-LIGHT VOTIVES

Transform regular tea-light votives into glamorous gilded décor accessories by following the same basic steps.



CANDLESTICKS

Create a dramatic atmosphere by gilding all your candleholders and grouping them together on a small table. Cover them with gold leaf completely or in part.

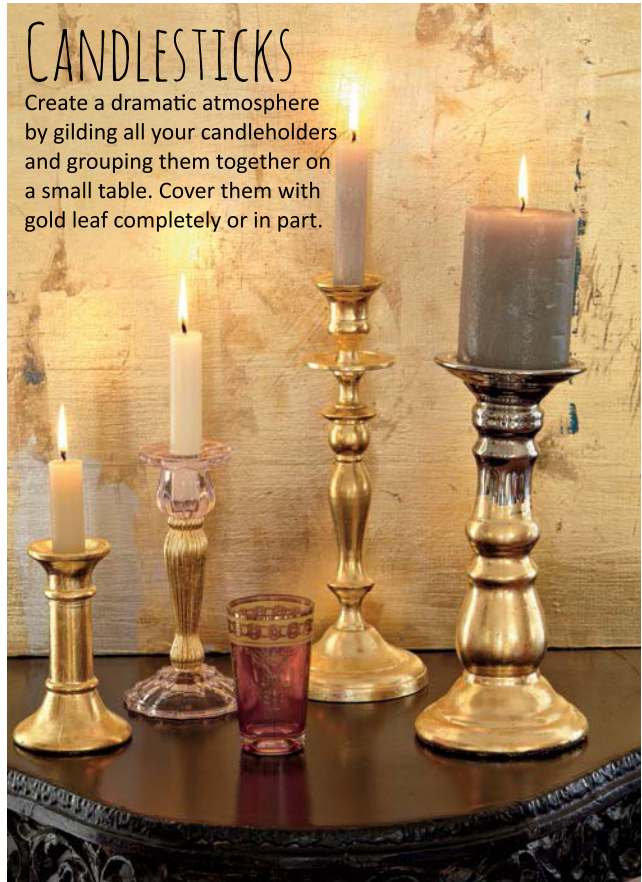

PAPIER-MÂCHÉ BOWLS

Make bowls from papier-mâché (see page 33 for the basic technique) and give them a touch of luxury by applying gold leaf on the inside.

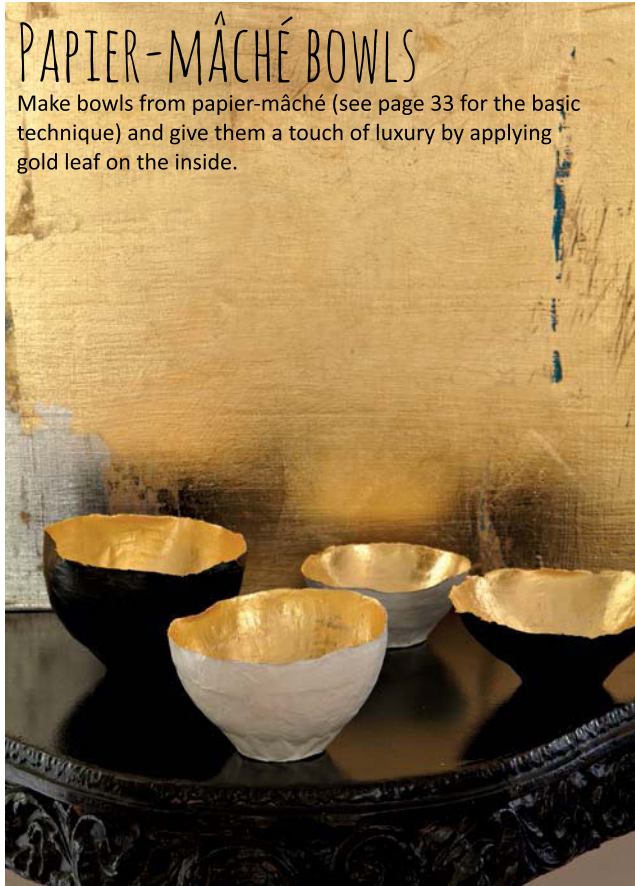

GLASS VASES

We used gold leaf on three identical glass vases, but at different heights. Use masking tape to make sure the lines are straight, or play around with interesting lines.

PREPARATION OF GLASS AND PLASTIC

Ensure that the item is free from dust and grease by washing it in a solution of vinegar and lukewarm water. Dry it properly.



ENAMEL JUG

Enamelware looks beautiful with some gilded edging.

PREPARATION OF METAL

If the metal is rusted, you should ideally first sand it with fine-grit sandpaper. Wipe it down with a damp cloth, then wash it in a solution of vinegar and lukewarm water to remove any greasy residue. Dry it properly. If you prefer, you can apply an undercoat to the item before you cover it in gold leaf.

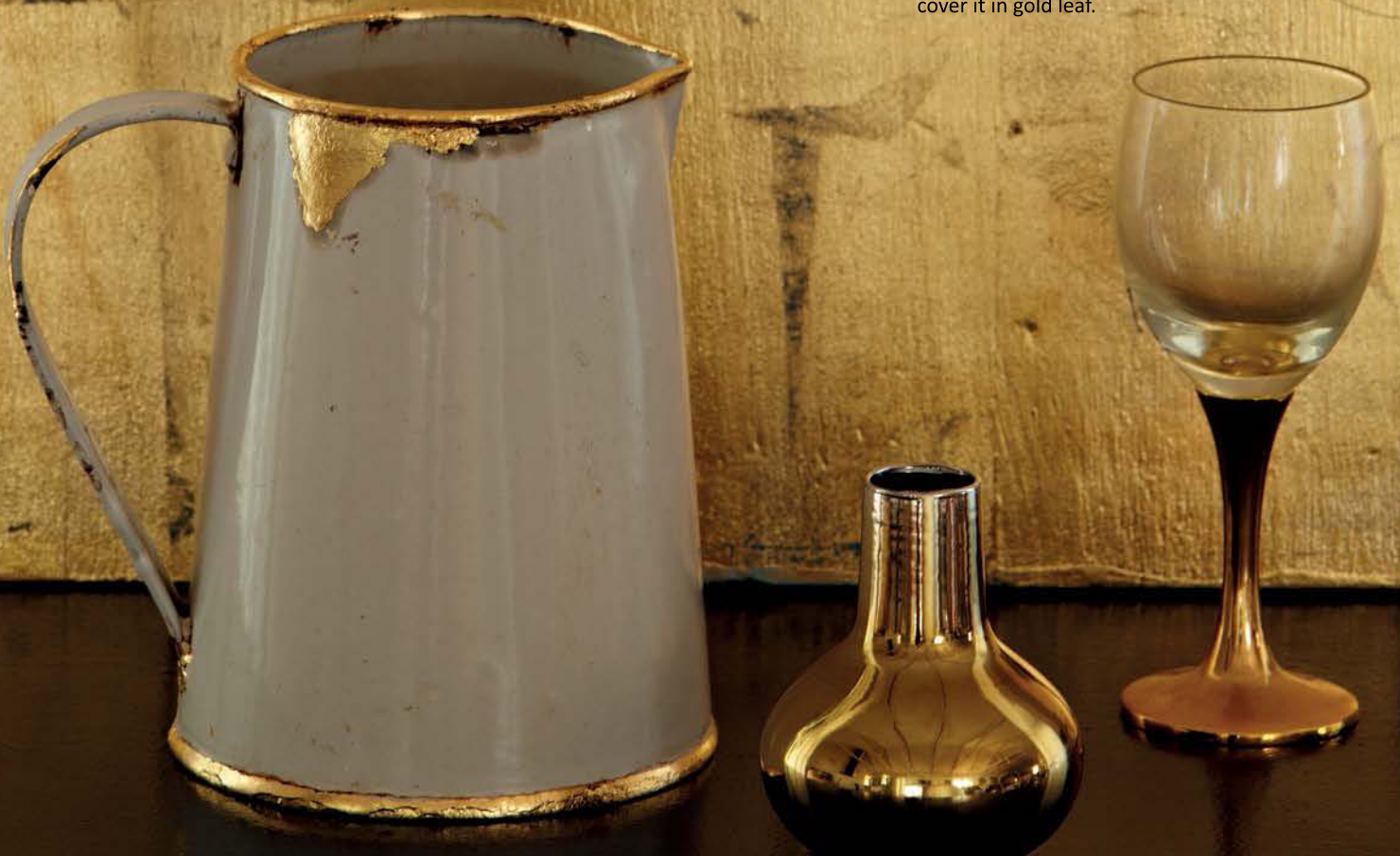

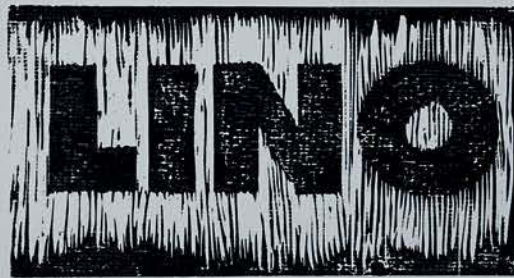
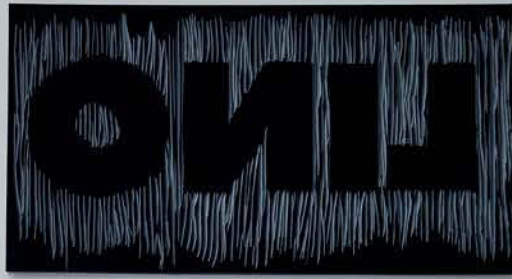

LEARN TO DO LINOCUT PRINTING
SO THAT YOU CAN MAKE YOUR OWN MARK.

You will need

paper or fabric item to decorate

stamp design

✿ rubber linoleum

✿ lino cutting tools

suitable paint or ink

✿ carbon paper

✿ ballpoint pen or hard pencil



STATIONERY WITH A TEAPOT MOTIF

Choose a motif that appeals to you or that reflects your business and use it to cut a linoleum stamp that you can use to print on a range of stationery.



CUT A MOTIF

You will need

motif of your choice

✿ rubber linoleum

✿ lino cutting tools

✿ carbon paper

✿ hard pencil or ballpoint pen

✿ masking tape

✿ scissors

1



Copy your motif in the size you want the stamp to be. Cut a piece of linoleum as well as a piece of carbon paper slightly bigger than the motif.

2



Secure the carbon paper to the lino with masking tape. Place the motif on the carbon paper. Trace over all the lines with a hard pencil or ballpoint pen to transfer the design to the lino.

3



Remove the template and carbon paper and go over the lines again with the ballpoint pen, to make them clearer.

4



Use a V-tip tool and carve away a groove around the design. Stay just outside the line and cut away from yourself, with your other hand behind the carving tool.

5



Complete the entire outline in this way. Work slowly and carefully rather than have your hand slip and make a mistake. Anything that is carved away will not be part of the printed motif.

6



Do the inner detail. Turn the linoleum around as necessary and remember, the harder you press, the deeper you carve away the lino. Continue to cut away from yourself.

7



Use a large half-round tip and carve away the background around the design. Carve away everything that must not be part of the printed motif.

8

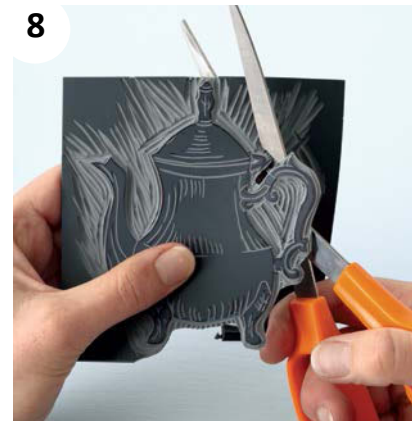

Trim away any excess lino with a pair of scissors or a craft knife (optional).

MAKE A LINO STAMP

You will need

- cut-out lino design 🌸 sponge paper (slightly larger than cut-out lino) 🌸 a piece of cork or a wooden block (slightly larger than the cut lino) 🌸 craft knife 🌸 cutting mat 🌸 strong glue



1 Turn over the cut-out lino design and smear the glue just inside the edge. Stick the lino onto the sponge paper and leave to dry.



2 As soon as the glue is dry, you can cut away the sponge paper around the lino with your craft knife.



3 Smear glue onto the back of the sponge paper and stick the sponge paper onto the piece of cork or the wooden block. Leave to dry.

PRINT YOUR OWN PAPER

You will need

- completed stamp 🌸 ink stamp pad in the colour of your choice 🌸 plain paper and envelopes



1 Get everything ready and test the colour of the ink on some scrap paper, if necessary. We bought A4 sheets of paper to use for our cards and cut them to the desired size.



2 Working relatively quickly, use your ink stamp pad to apply ink all over the stamp so that the entire motif is evenly coated.



3 Turn the stamp over and press the motif onto your paper. Press lightly with your hands so the entire motif prints clearly.



4 Lift the stamp carefully and repeat the process with the rest of your paper.



Tip

If you don't have an ink stamp pad, you can apply ordinary craft paint to your stamp using a sponge brush. Test the paint first to ensure that it prints well on your paper.

PLACEMATS

Make linocuts of a row of houses using the templates on page 31 and use them and fabric paint to stamp a design onto placemats.



STAMP A PICTURE

Make a lino stamp of an illustration, print it onto paper and frame it. You can also use your stamp to decorate cards and wrapping paper.



Frame it

We framed our stamped design in a cardboard box. Build your own frame: trace a pretty frame in the desired size onto paper – you can copy our frame template on page 30 – and cut it out. Stick it onto firm cardboard, cut it out and build the rest of the box on the inside edge of the frame. Stick your picture inside the frame with double-sided tape.

You will need

- template on page 30
- linoleum
- lino cutting tools
- ink pad
- carbon paper
- masking tape
- double-sided tape
- craft knife
- cutting mat
- metal ruler

1

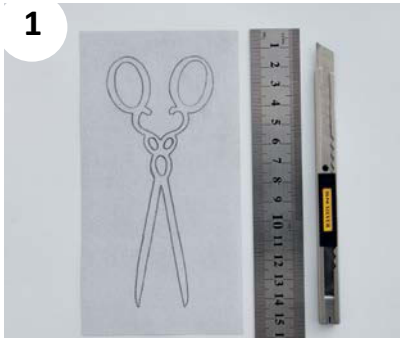

Copy the template on page 30 (or your own picture) in the desired size and cut away the excess paper.

2



Cut a piece of linoleum slightly larger than the picture.

3



Place your picture on a piece of carbon paper and stick it to the lino with masking tape. Trace over the lines to transfer the design to the lino – use a ballpoint pen or hard pencil.

4



Remove the picture and carbon paper and go over the lines on the lino again to darken them.

5



Use a V-point cutter to carve around the outlines. Stay outside the lines and cut away from yourself with your other hand behind the cutter. Work carefully – the parts you cut away will not be part of the stamped motif.

6



Now use a large half-round cutter and carve away the background around the design. Remove everything that must not form part of the final stamped motif.

7



Cut off the excess lino. Use double-sided tape to stick the linocut scissors onto something hard, like a piece of wood or Perspex, to make your stamp.

8



Use an ink pad to apply ink all over the stamp – work quite quickly so that the ink doesn't dry.

9



Test the stamp first on a piece of scrap paper. Press the stamp down lightly with your hands so the motif prints clearly. If necessary, you can cut away more of the lino. Apply more ink and stamp onto the paper of your choice – we used paper from an old book.

TEMPLATES

Scissors

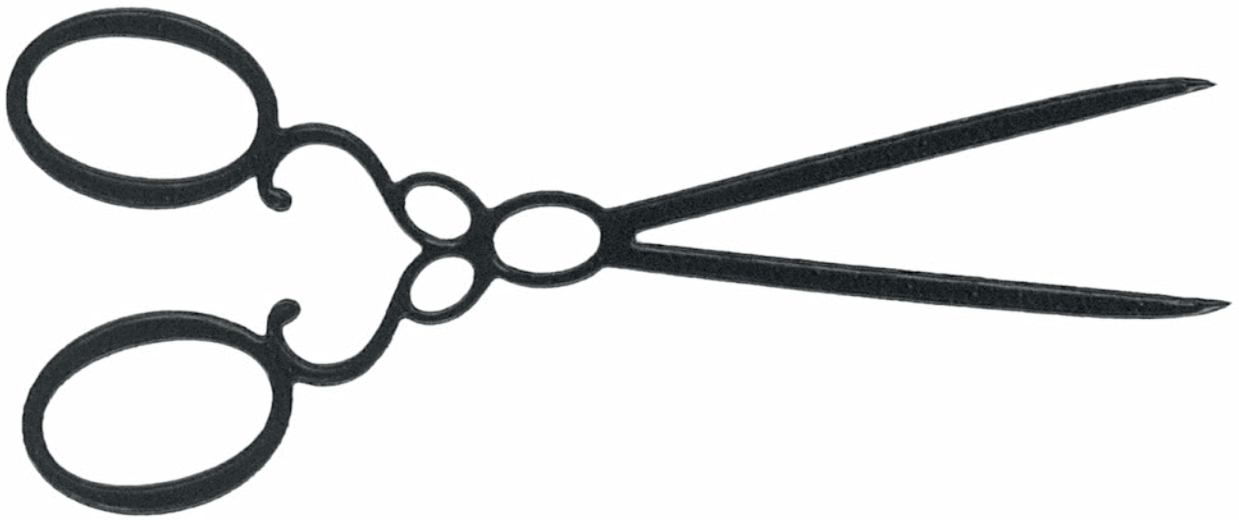

Frame for box

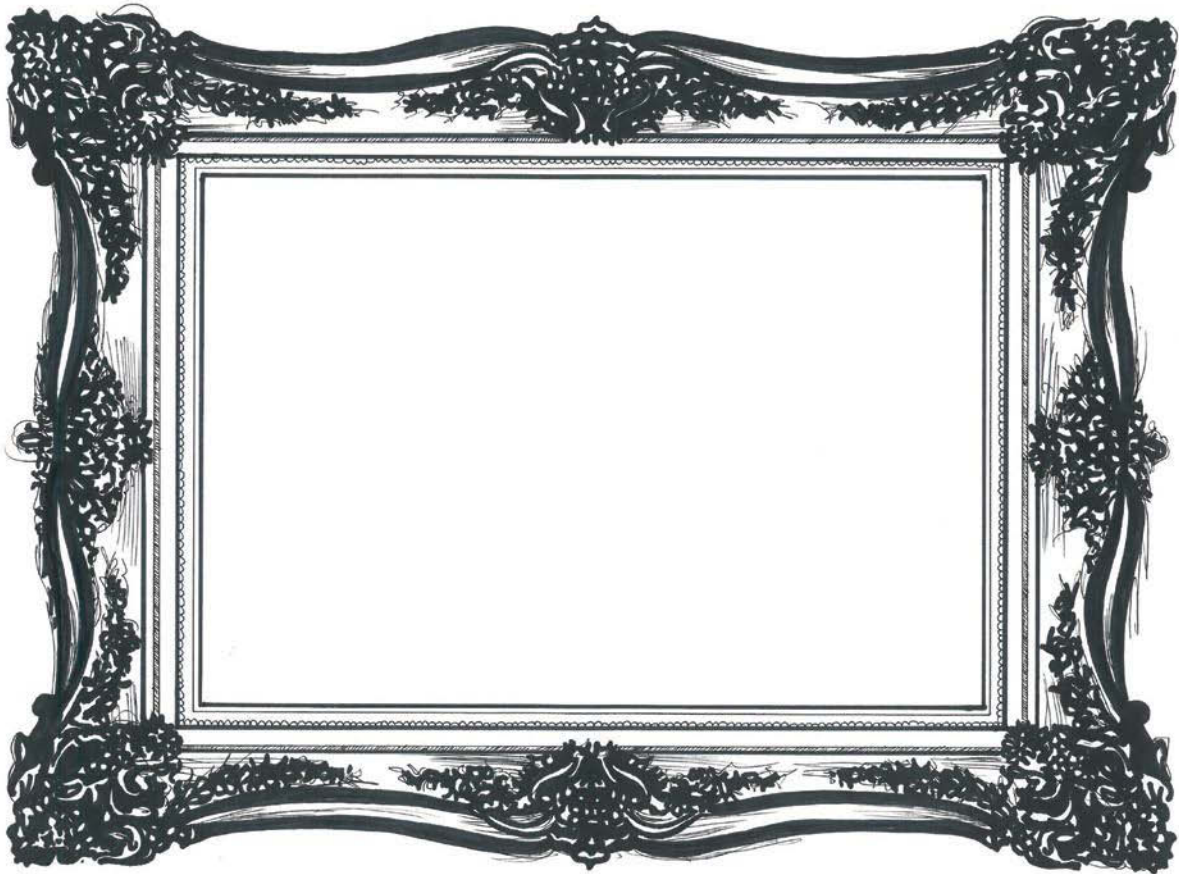

Stamp kit

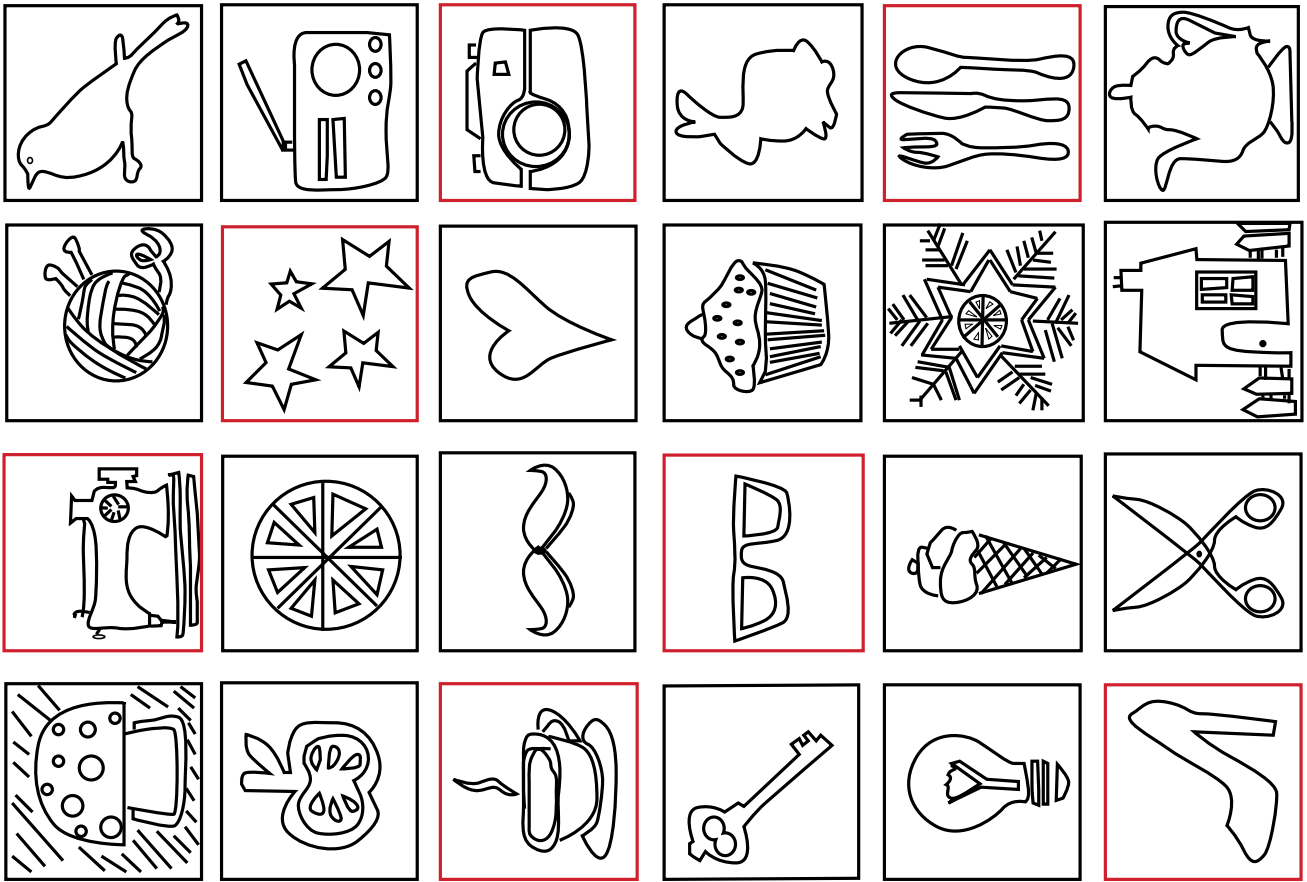

Row of houses



PAPIER- MÂCHÉ

WE SHOW YOU STEP BY STEP THE ART OF PAPIER-MÂCHÉ,
WITH SOME GORGEOUS PROJECTS AS INSPIRATION.

Papier-mâché glue

You can also use diluted cold glue, but it's easy and cheap to make your own glue.

You will need

4 cups water

1 cup flour

salt



To make glue

- 1 Pour three cups of water into a pot and bring to the boil.
 - 2 In the meantime, mix the flour with the last cup of water to form a smooth paste.
 - 3 Add the paste to the boiling water and stir immediately to prevent it burning. Leave it to simmer until it is sticky – it takes a few minutes – before you take it off the heat.
 - 4 Stir a couple of teaspoons of salt into the mixture – it helps it to keep longer – and leave it to cool.
- TIP** If your mixture is very lumpy, you can use a stick blender to remove the lumps.
- 5 Use the mixture as glue only when it has cooled completely. It will keep for a few days in the fridge.

How to do papier-mâché

There are two basic methods. The one involves tearing paper into small strips and then sticking the strips in layers onto an object, usually a balloon, with cold glue or wallpaper paste. In the other method, pieces of paper are soaked in water to make a porridge-like mixture. This is then drained and mixed with glue to create a paste that you can then form into a doll or ornament. In both methods, wait until the paper is dry and hard before painting or decorating it.



MOTHER RABBIT

1



Plan how large you want to make your papier-mâché doll or animal and more or less what it should look like. Our rabbit is 15cm tall. We used a small, long balloon for the head and body (the kind that you use to make balloon animals), but you could also use larger balloons.

2



Inflate the balloon to the correct size. Twist the top section a few times to form the head then secure with a piece of string. Cut off the ends of the string.

3



Thin three parts cold glue with one part water. Paint this mixture over a section of the balloon and stick pieces of newsprint onto it. Paint more glue over the top. Continue until the balloon is covered then leave it to dry. **NOTE** Tear the paper into pieces, don't cut it with scissors as it won't adhere as smoothly.

You will need

template for rabbit's ears, arms and legs on page 40

newsprint (unprinted), torn into small pieces

old book pages, torn into pieces

🌸 balloons

balloon pump

🌸 cold glue

mixing bowls

🌸 paintbrushes

thin wire

wire cutter

🌸 craft paint

gum tape

🌸 fabric remnants for the clothes

🌸 ribbon or cord

thin string or knitting yarn

embroidery thread and needle

sewing thread and needle

4



While waiting for the first layer to dry, form the arms, legs and ears with thin wire. Use our template on page 40 as a guide or shape your own.

TIP You can also use balloons, pipe cleaners or strips of rolled-up paper to form these parts.

5



Fill in the ears, feet and hands with pieces of paper and glue another layer of paper over the body if needed. Leave to dry properly.



6 Secure the wire sections to the body with wet gum tape.
NOTE Gum tape works best as other types of tape come loose when they are wet. Tear long paper strips to wrap around the legs and arms and stick in place with cold glue. For the feet, crumple up pieces of paper and stick in place. Cover with paper strips.



7 Complete the entire body and then strengthen the arms, legs and ears in the areas where they are attached to the body. Also cover the gum tape with pieces of newsprint. Leave to dry overnight.



8 Now stick pieces of the old book pages over the entire body as before and leave to dry properly.



9 In the meantime, cut out the fabric pieces for the rabbit's dress with your pinking shears. The top part is 25 x 6cm and the bottom part 25 x 7cm (so that it sticks out a little at the bottom). With right sides facing, sew the two strips together at their short sides and then turn through to the right side. Work a row of tacking at the top of the dress so that you can gather it in later. Cut out the centre sections for the ears and cut the ribbon or cord so that it fits as a belt around the body. We cut another length for the dress's straps. We worked the eyes, nose and mouth with embroidery thread on a book page and then tore out the sections and glued them in place. Also glue the fabric ears in position and leave to dry.

PET PIGLET

The pet of the family! His body is formed around a small water balloon and his ears and tail are shaped from wire. For the trotters and snout we rolled paper into balls and glued them to the body. Decorate further, as with the rabbit.

TIP If your piglet is 'nose heavy' or topples to one side, add a heavy object like a washer to the belly to counter the weight. Cover with some more paper.



10 Mix some craft paint in the colour of your choice and paint a thin coat over the entire doll so that the printed text still shows through. We also painted the feet pink. Once the paint is dry you can dress the doll and pull in the gathering stitches. Work the belt in place over the top edge, fold the cord for the straps in half and secure.

FAUX PAPIER-MÂCHÉ PLATES

Decorate your old crockery with pictures of flowers. Use diluted cold glue or our recipe for papier-mâché glue on page 33 to stick strips of newspaper onto a plate. Brush over more glue as you paste. Leave to dry, and then stick on another layer. Paint over the paper with white acrylic paint and, when it is dry, decorate with floral designs that you have cut out roughly (copy our template on page 41, or use your own pictures, if you prefer). Seal with a suitable varnish. Make a whole collection to display on a table. To use the plates to display food, put the food on a wire rack or line the plates with baking paper first.



NESTS FROM PAPER

You will need

- ✿ **strong, large balloons**
-
- newspaper, torn into strips**
-
- papier-mâché glue**
-
- ✿ **craft paint in the colour of your choice**
-
- ✿ **sponge brush and craft brush**
-
- ✿ **black marking pen**
-
- ✿ **masking tape**
-
- ✿ **baker's twine or embroidery thread**

To make

- 1 Inflate the balloon and then stand it, with the knot facing upwards, in a cup so that it stays steady while you work. Stick down the knotted end onto the balloon with masking tape.
TIP Pour a little fine sand into the balloon to make it a bit heavier, so it stays in place.
- 2 Mark the opening of the nest on the balloon with a marking pen.
- 3 Paint glue over the balloon using the sponge brush, stick on a layer of newspaper strips and paint more glue over the top. Rub the paper with your fingers to smooth it as you go. Work around the opening and complete the first layer. Leave to dry overnight.
REMEMBER It is very important that each layer is properly dry before you continue; you will need to do three to four layers.
- 4 Stick on more layers until your shape is sturdy – we did four layers.
TIP Use white paper or unprinted newspaper for the last layer if you want to paint the nest white.
- 5 Prick the balloon with a pin and carefully remove it when you are sure that your papier-mâché nest is firm and dry enough. Be especially careful if you have used sand.
- 6 Stand the nest in the cup again and paint it with one or two coats of craft paint in the colour of your choice. Leave to dry.
- 7 Make a small hole in the top of the nest using a sharp instrument (we used a drill bit that we turned by hand to make the hole). Tie a knot in the end of some baker's twine or embroidery thread and insert it through the hole from inside so you can hang the nest up later.
- 8 Decorate the nest as you prefer.



PAPER GARDEN IN A NEST
Use spray glue to stick flower illustrations onto sturdy cardboard. Cut out the illustrations with your craft knife leaving a 1cm-wide strip of extra cardboard at the bottom, to form a 'foot'. Cut out flowers of different sizes and heights for the foreground and background. Bend the 1cm strip into a stand. Using a glue gun, work from the back towards the front to stick the flowers into the nest.

NEST WITH STAMPED TISSUE PAPER
Rubber stamps are an easy way to decorate things. Buy an inkpad in the colour of your choice, press the stamp into the ink and print it onto tissue paper. Print a few and cut them out around the outline. Paint a layer of modge podge over your nest, place the stamped paper on top and paint on another layer of modge podge. We decouaged one design around the opening of the nest and another over the nest in a strip.

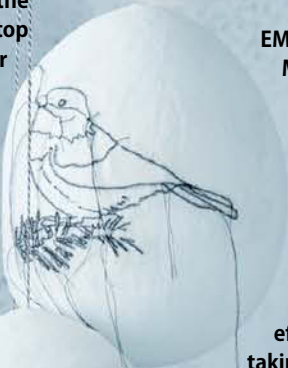

EMBROIDERED NEST
Make a stitched bird illustration for your papier-mâché nest. We used black sewing thread and worked the design on page 40 onto rice paper, which is firm enough to decoupage while still being pliable. Leave the ends of the threads long and loose, to create an interesting effect. Cut out the design, taking care not to snip the threads. Decoupage it onto the nest.



NEST WITH A FRAMED OPENING
Use the frame template on page 40 or another oval or round frame to decorate your nest. Make sure it is the correct size for your nest's opening. Cut it out neatly and cut away the inside section with your craft knife. Fit it over the nest's opening and start decoupageing it from the opening outwards with modge podge. Cut notches or panels, as necessary, to shape the frame neatly and rub the paper to smooth it as you work.



PAPIER-MÂCHÉ MATRYOSHKA

Blow up balloons in different sizes to make the various sizes of dolls.

You will need

- ✿ balloons
- balloon pump
- newsprint (preferably unprinted), torn into narrow strips
- ✿ cold glue
- ✿ white PVA paint or craft paint
- ✿ craft brushes
- ✿ masking tape
- paper cups

To make

1 Decide how big you want the doll to be – our largest one is 25cm tall and the smallest is 12cm. Use small water balloons for the smaller dolls.

2 Blow up the balloon to the desired size and stick a piece of masking tape around the centre to make the 'waist' – be careful not to burst the balloon.

3 Cut the top off a paper cup, about 1cm down from the lip, and stick it with masking tape to the large end of the balloon.

4 Mix three parts cold glue to one part water in a container. Paint the diluted glue over a section of the balloon and stick a strip of newsprint onto it. Paint more glue over the top. Cover the whole top section of the balloon in this way. Turn the balloon over and place it in a clean paper cup. Leave it to dry completely.

NOTE Don't cut the paper strips with scissors – the torn edges of the paper actually give a smoother finish.

5 Turn the balloon around as soon as the top is dry and repeat the process for the bottom. Leave overnight to dry properly.

6 Do another two layers and then, when your doll is completely dry, paint it with white PVA paint.

Decorate your doll

There are many possibilities: you can paint her, decoupage bits of serviette or fabric onto her, and use buttons, washi tape and even gold or silver leaf for extra decoration. The face detail can be drawn with thin-tipped marking pens.



**Bird for nests
(page 37)**

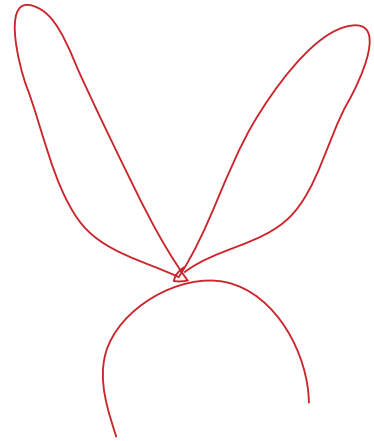
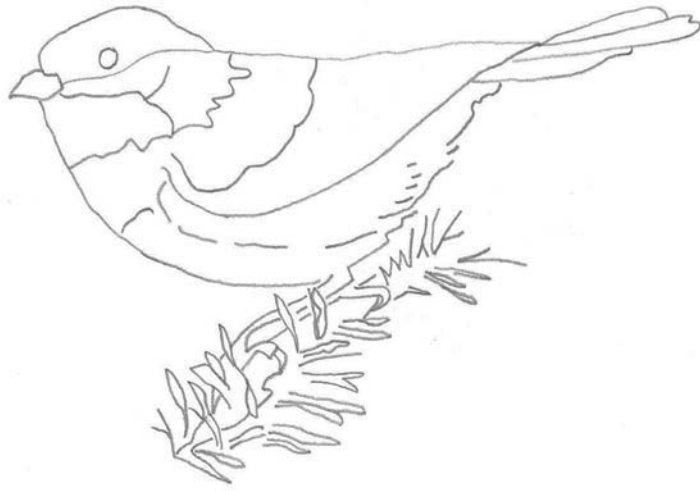

**Frame for nests
(page 37)**

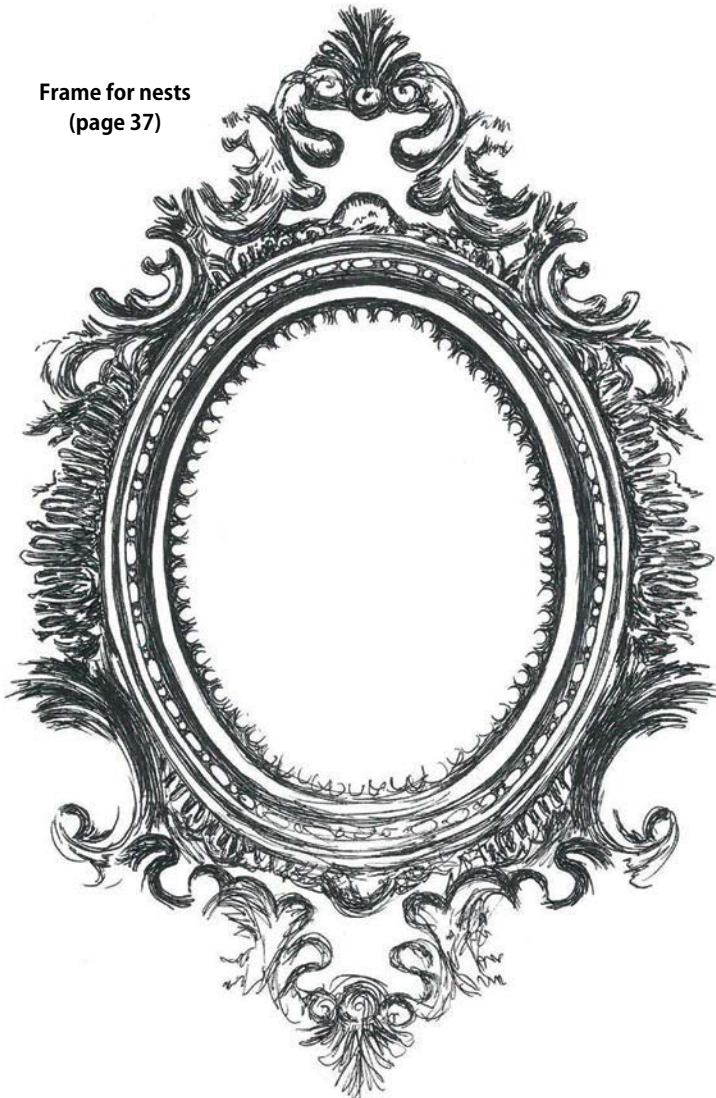

**Rabbit's
ears, arms
and legs
(page 34)**

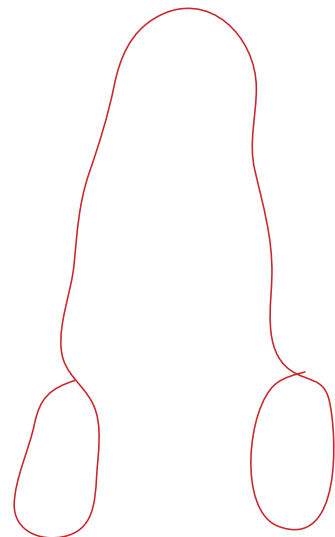
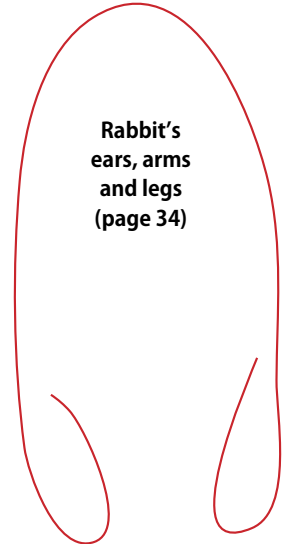



DECOUPAGE

LEARNING THIS FUN CRAFT WILL ENABLE YOU TO DECORATE JUST ABOUT ANY HOUSEHOLD ITEM – THE POSSIBILITIES ARE ENDLESS.

You will need

- item to decorate
- ✿ motif (usually cut from paper or fabric)
- ✿ modge podge
- ✿ sponge brush and sponge rollers
- ✿ paintbrushes
- ✿ sandpaper (for a smoother finish)
- ✿ clear varnish or resin (optional)
- ✿ craft knife, cutting mat and scissors

What is decoupage?

Decoupage is the art of decorating the surface of an object with shapes or illustrations, usually cut from paper or fabric. The motifs are glued in place with modge podge, which is a sealant, adhesive and varnish. It's water based and has a milky appearance initially but dries to a clear finish.



What items can I use for my decoupage projects?

- wood • metal • galvanised steel
- enamel • glass • ceramics • fabric
- candles • soap

General technique

1 Wash and dry the item to remove any grease. Prepare the item correctly before you start: lightly sand away rust, paint it, or block off sections with masking tape. If the surface is porous, such as wood, you can seal it with a layer of modge podge.

2 Think about how you want to decorate the item and cut the motifs accordingly.

3 Paint a thin coat of modge podge over the section where you will begin, place a motif on the modge podge and paint over it with another coat of modge podge. Try to apply the modge podge in a crisscross fashion for the best coverage.

4 Carefully smooth out any wrinkles.

5 Repeat these steps until you are finished. Each coat of modge podge needs to dry properly before you apply the next. Sand lightly for a smooth finish then paint on more coats of modge podge. Leave to dry properly, preferably overnight.

6 When the modge podge is completely dry, you can seal the item with a clear varnish, if you prefer. There are several varnishes that are specially formulated for decoupage. You can also use resin, if it is suitable for your project.

SEWING MACHINE

If your gran's old sewing machine is rusted or looks past its prime, a new decoupage jacket will make you want to put it on display again. We painted the areas that we wanted to decorate with a universal undercoat before we decoupage it. Cover it in layers of old sewing patterns. To finish, we added a rose motif here and there.



DISPLAY PLATES

We took photos of a couple of pretty plates, printed them out onto paper and then used these pictures to decorate other plates. Cut the pictures to the correct size then cut them in half. Use the halves to decorate one half of each plate. You can also use a plain white plate and decoupage it with two different photo halves. Smooth out all the creases, especially over the curved sections.





FOCUS WALL

We used decoupage plates (see the facing page) and added a strip of decoupage wallpaper to create a focus wall. Use a roll of leftover wallpaper (or heavy-duty plain paper) and photos of plates to make this decoration. Arrange the photos on the back of the wallpaper, decoupage them in place then hang up the wallpaper.

STYLISH SERVING PLATTERS

You will need

- wooden serving boards
- pretty, thin paper (such as giftwrap)
- modge podge
- non-toxic varnish
- brushes
- rough sandpaper
- craft knife, cutting mat and metal ruler

1



Have your paper ready – we used colour photocopies of various designs of scrapbooking paper. Cut the paper slightly larger than the wooden board.

2



Keep the paper on hand and paint the wooden board with a coat of modge podge.

3



Place the paper on the board while the modge podge is still wet and paint another coat of modge podge over the top. Rub the paper smooth and leave it to dry overnight.

4



Sand the edges of the board so that the paper comes off here and there and you can see the wood again. Sand the board in a few more small places so that it looks quite weathered.

5



Paint the board with another coat or two of modge podge and leave it to dry overnight.

6



Seal with a coat of non-toxic varnish such as Woodoc's polyurethane sealant. Leave it for seven days to set properly before you use the board. You will then be able to wash it by hand in warm, soapy water.



For visitors to cover book, it requires it, well look in

21 22 23 24 25 26 27 28 29 30 31 32 33 34 35 36 37 38 39 40 41 42 43 44 45 46 47 48 49 50 51 52 53 54 55 56 57 58 59 60 61 62 63 64 65 66 67 68 69 70 71 72 73 74 75 76 77 78 79 80 81 82 83 84 85 86 87 88 89 90 91 92 93 94 95 96 97 98 99 100

FRESH START FOR AN OLD CASE



1

Wash the suitcase with a sugar-soap solution and leave to dry. Measure the various panels and write down all the measurements – it's a good idea to do it on a small sketch. **NOTE** If you want to paint the suitcase's locks and handle, do so before you cover the case in fabric.



2

First cut the pieces from the unbleached linen so that you can use them as your pattern. We used separate pieces for the top and side panels, and one long piece for the front, base and back. Cut the pieces according to your measurements and label them.



3

Press all the pattern pieces as well as your patterned fabric to remove creases. Pin the pattern pieces to the fabric and cut them out with a 3cm allowance included for folding over the edges.



4

Place the fabric pieces right side up on a plastic sheet or a black bag, then paint over a coat of modge podge. Leave to dry overnight – the fabric will come away from the plastic easily when it is dry.



5

Put the piece for the front, base and back right side down and place the case on top. Mark the positions of the locks and handle. Cut crosses with your craft knife at the marks and cut a slit for the handle. Paint modge podge over the front of the case and to the edge of the matching fabric section.



6

Rub the fabric onto the front of the case and fold over the edge. Paint on modge podge. Smooth out any bubbles and wipe off excess modge podge with a damp cloth. Make sure the edges of the slit for the handle meet neatly, and cut away around the locks and handle ends. Cover the base and back in the same way.



7

Peg the linen pattern pieces for the sides in position. Trace the shape right around 0,5cm inside the edges and cut out on the new line.



8

Pin the side-panel pattern pieces to the fabric pieces and trim to fit, but leave a 3cm allowance on the top edge.

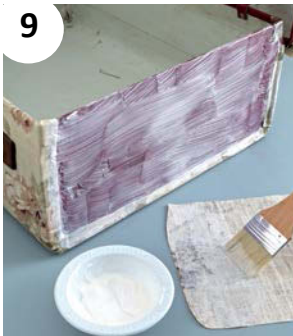

9

Check that the fabric piece fits and cut away more, if necessary. Paint modge podge over the side of the suitcase and the wrong side of the fabric.



10

Stick the fabric in position as before and paint another coat of modge podge over it. Repeat for the other side panel. Complete by decoupageing the fabric to the top of the suitcase in the same way.

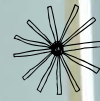

Tips

Keep a container of warm water on hand to wash your hands in as you work so you don't dirty the fabric. Spray a little water over the fabric if it is too stiff to work with.

You will need

- old suitcase
- patterned fabric
- unbleached linen (calico)
- sugar soap
- modge podge
- brush
- plastic dropsheet (or black bag)
- craft knife
- needlework scissors
- dressmaker's pins
- measuring tape
- pencil
- paper
- pegs



PATCHWORK TABLE WITH DECOUPAGE TILES



Patchwork mosaic

Decorate plain wall tiles of various sizes with fabric and hand-drawn designs. Leave some plain too. Combine them with small glass tiles in matching colours to turn a coffee table into a work of art. You can also have a piece of wood cut to the size of your choice and decorate it in the same way, to use as a wall decoration, splashback or a headboard for your bed.

Before you start

If you're not going to use grout between the tiles, paint the table top or piece of wood in the colour of your choice to create a background for the mosaic. We used a pink water-based enamel. Leave the paint to dry completely before you start the mosaic work.

You will need

wooden table top or wooden board

fabric tiles (project on facing page)

hand-drawn, glazed ceramic tiles

✿ **selection of smaller ceramic AND**

✿ **glass tiles**

✿ **tile glue**

✿ **tongue depressor or ice-cream stick**

✿ **sponge paper and strong glue OR**

✿ **double-sided mirror tape (optional – see step 3)**

✿ **grout (optional)**

✿ **palette knife or rubber spatula**

(optional – see step 5)

To make

1 Start by laying out the larger tiles. Move them around and arrange them until you're happy with the design. Place the tiles in such a way that there are very few big gaps between the individual tiles. Also keep the repetition of the colours in mind.

2 Fill the gaps with smaller ceramic and glass tiles, moving all the tiles around if necessary to create the best possible layout for your table.

3 If you're making a table top and are going to be using grout, and want the tiles to be level, you can use sponge paper and strong glue, or double-sided mirror tape, to 'lift' some of the thinner tiles. Cut the sponge paper or double-sided mirror tape into squares that are just smaller than the tiles, then stick the squares to the back of the tiles. If you've used sponge paper and glue, leave the glue to dry completely before you continue with your project.

TIP Stick the sponge paper or double-sided tape over the entire back of the tile so that it doesn't crack if something heavy is placed on it.

4 Working systematically from one side, glue on the tiles with a suitable adhesive (we used Alcolin Flexi-Tiler Adhesive). Use a tongue depressor to make it easier to apply the tile glue to the tiles.

5 If you're using grout, you can now fill the spaces between the tiles. Mix the grout according to the manufacturer's instructions and use a palette knife or rubber spatula to work the grout into the spaces. Wipe away the excess grout with a damp sponge, leave to dry a little then wipe down again with a clean, damp sponge. Repeat until the tiles are completely clean, then leave to dry. To complete, polish the tiles with a dry cloth, if necessary.

You will need

- ✿ undecorated tiles
- ✿ remnants of fabric (preferably cotton)
- ✿ modge podge
- ✿ craft brush
- ✿ craft knife and cutting mat
- ✿ resin
- ✿ paper cups
- ✿ tongue depressor or ice-cream stick



1 Cut the fabric slightly larger than the tile that you want to decorate.



2 Paint the tile with a coat of modge podge and leave to dry completely.



3 Paint the tile with another coat of modge podge. Also apply modge podge to the wrong side of the fabric.



4 Place the fabric on the tile while the modge podge is still wet. Smooth out any bubbles. Paint modge podge over the fabric and leave to dry.



5 Turn over the tile and neatly trim the excess fabric around the edges with a craft knife.



6 Seal the fabric-covered tile with a final coat of modge podge, then leave to dry completely.



7 Mix the resin in paper cups, following the manufacturer's instructions precisely. Weigh or measure the quantities accurately. (Be aware though that you won't be able to reuse the measuring cups.) Pour a little of the mixture onto the tile and spread it out over the top of the tile using a tongue depressor or ice-cream stick. Leave to dry and harden in a dust- and draught-free area.



TIP

We mixed our resin by combining one part Araldite HY 2963 with two parts Pacote 600. We used 60g and 30g respectively, which was enough for 16 tiles of 107 x 107mm each. You can also use Pratley Kraftex PratleyGlo. (See page 60 for our resin projects.)



TRANSFER

BEING ABLE TO TRANSFER PHOTOS ONTO FABRIC, GLASS
OR TILES OPENS UP A WORLD OF CREATIVITY.
WE SHOW YOU HOW TO MASTER EACH OF THESE TECHNIQUES.

You will need

digital photo or picture

transfer medium suitable for your project

suitable surface or object to transfer onto



FIND
MORE
FREE
MAGAZINES

[HTTP://SOEK.IN](http://soek.in)



What is picture transfer?

The basic idea is to transfer a photo or picture of your choice onto anything from fabric to glass and wood by using the correct medium. The methods differ slightly, depending on the surface onto which you are printing.



You will need

unglazed tile (for example, a travertine tile)

picture or photo with graphic design

nail-polish remover with acetone base

cotton wool

bone folder (or use a teaspoon)

tile varnish or sealant

🌸 sponge brush

INK DESIGNS ON TILES

1



Measure the tile and print out your picture or photo on a laser printer so that it is slightly larger than the tile. Cut it out.

NOTE The tile must be of a natural material and unglazed, which is why travertine tiles work best.

2



Place the tile in the microwave for one minute on high (the heat will help the ink transfer more easily) then remove it using oven gloves. Place the picture ink side facing downwards onto the tile. Rub over the back of the picture with a piece of cotton wool that has been dipped into nail-polish remover – make sure the picture doesn't move around.

3



Continue to rub the nail-polish remover over the picture until the paper is saturated and sticks to the tile. Use a bone folder or the back of a teaspoon to rub over the wet paper until the ink transfers onto the tile. Apply more nail-polish remover if it evaporates. The paper may tear as you work, but it doesn't matter, as long as the ink comes off onto the tile.

4



Carefully remove the paper from the tile. If some of the paper sticks, rub it off with your fingertips.

5

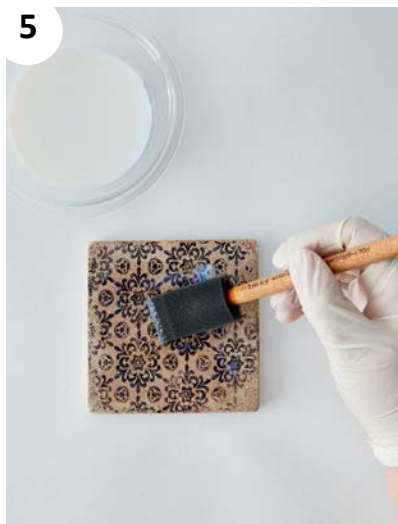

Use your sponge brush and seal the tile with a suitable tile sealant like Alumination Sovereign Seal.

6

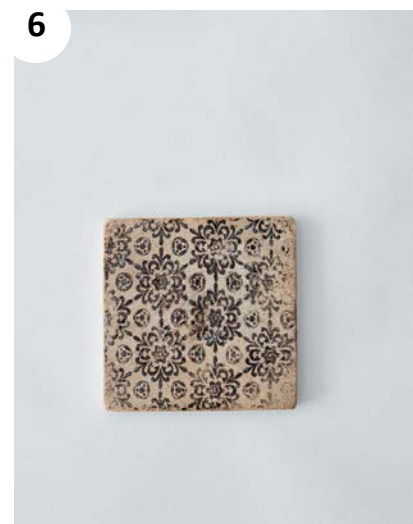

NOTE Only use nail-polish remover containing acetone; pure acetone or thinners will not work.

DRESS PHOTO ON BED LINEN

To make

1 Use a photo editing program to enlarge your photo and divide it into A4-sized sections. We divided ours into six pieces. (If you do not have an editing program, you can have it done for you at a shop that offers this service.)

2 Print out the different parts of the photo onto the transfer paper using an inkjet printer (not a laser printer) and leave them to stand

for five minutes so the ink can dry. Cut out the photos along the outline of the dress. We used transfer paper for dark fabric, as it gives a deeper colour, but you can use the paper for light fabrics, if you prefer.

3 Place the duvet cover on a hard surface for ironing and make sure that there are no creases in the fabric. Set your iron to the hottest temperature with the steam function switched off.

4 Remove the back layer from the first photo. Place the printed part photo-side upwards on the duvet. Cover it with the baking paper.

5 Iron the photo onto the duvet cover. Don't press too hard on the iron. Work with a circular motion and iron all over, also in the corners and at the edges. It should take about four minutes per A4 photo.

6 Remove the baking paper and repeat until all the sections are done.



You will need

white duvet cover

high-resolution digital photo

🌸 iron-on transfer paper for dark fabric

baking paper (sometimes included with the product)

* Iron-on transfer paper is used for fabric.

CITYSCAPE ON A PERSPEX CHAIR

You will need

glass, plastic or Perspex item that you

want to decorate

high-resolution digital photo

waterslide transfer paper

absorbent paper towels

suitable mineral varnish

To make

1 Measure the section that you want to decorate so you know how big to print your photo. Print the photo according to the measurements using a laser printer onto a sheet of waterslide transfer paper and cut it out.

2 Pour a little lukewarm water into a large enough container and place the photo print in the water so that the glue between the two layers of transfer paper softens. Make sure the area where you are going to place the photo is clean and dry and there is no oiliness.

3 As soon as the glue is soft, take the photo out of the water and carefully slide the printed layer from the back paper into the correct position. Take care not to tear the picture.

4 Rub the picture lightly with absorbent paper towel to smooth it then leave it to dry. Discard the paper layer.

5 Seal the print with a mineral varnish such as Pratley Kraftex Seal Coat, or use resin for a more permanent finish.

*** Waterslide transfers are used to apply images to non-porous surfaces.**



FLOWERS UNDER GLASSES

You will need

digital photo or picture of a flower

waterslide transfer paper

set of glasses

absorbent paper towel



1



Measure the base of your glasses and create circles of the same size in a Word document. Place a photo or picture of a flower in the middle of each circle. Print with a laser printer onto the waterslide transfer paper – make enough for all your glasses. Cut out around the edge of the circle.

2



Place a little lukewarm water in a container and leave the first picture to lie in the water until the glue layer has softened. Wipe the bottom of the glass so it is clean and dry and place the glass upside down.

3



When the glue between the two layers of the transfer paper is soft, remove the picture from the water and slide the printed layer carefully onto the bottom of the glass.

4



Carefully wipe the picture dry with a piece of paper towel and make sure it is completely smooth. Decorate your other glasses in the same way and leave them to dry properly before you use them.

5



TIP The transfer paper will come off your glasses when you wash them, unless you seal it first. We used a layer of Pratley Kraftex Pratliglo resin, so that the glasses can be washed by hand.



RESIN

WORKING WITH A CLEAR MEDIUM LIKE RESIN MEANS YOU CAN 'PETRIFY' ANYTHING IN IT, SEAL PHOTOS WITH IT, OR USE IT TO DECORATE ALL SORTS OF DÉCOR ITEMS.

You will need

base or mould

✿ pictures or decorations of your choice

✿ resin and hardener

✿ tongue depressors or ice-cream sticks

rubber gloves





What is resin?

Resin is a transparent material that becomes hard when it sets and then looks like clear plastic.

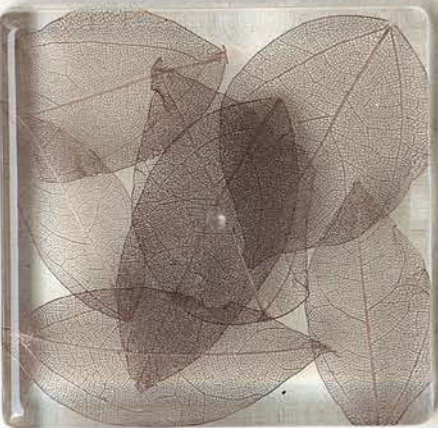
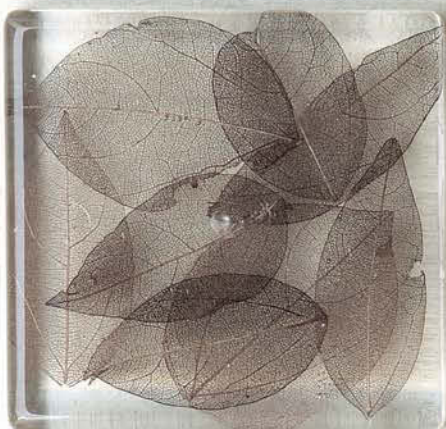

Moulded resin coasters (instructions on page 67)

FRIDGE MAGNETS

You will need

- 🌸 pictures of your choice
- 🌸 piece of cardboard
- 🌸 glass mosaic tiles
- 🌸 small magnets
- 🌸 resin or high-gloss polymer coating
- 🌸 epoxy glue
- 🌸 modge podge
- 🌸 paintbrush
- 🌸 craft knife, cutting mat, metal ruler
- 🌸 toothpicks
- 🌸 tongue depressors or ice-cream sticks



Use your craft knife, cutting mat and metal ruler to cut a window in a piece of cardboard the same size as the mosaic tiles (ours are 25 x 25mm).



Use the window to draw blocks the same size as the tiles over the pictures that you want to use for the magnets. Cut out the pictures.



Paint a mosaic tile with modge podge and place a picture on top. Paint another coat of modge podge over it to seal it and to make it stick. Leave to dry then paint on more modge podge. Repeat with all the pictures you want to use for magnets.



Prepare the resin or polymer coating according to the manufacturer's instructions. We used Pratley Kraftex Pratliglo. Mix enough to cover all your tiles with a layer.



Use a tongue depressor or ice-cream stick to drop a little of the mixture onto the first tile. Take care not to use too much, as it must just reach the edges and not run over.



Spread the mixture carefully into the corners with the stick so the top of the tile is completely covered. Repeat with all the other tiles. Set aside to harden – the time needed for this will depend on the product used.



When the resin is hard, turn the tile over and place it picture-side down on your work surface. Take a toothpick and mix the epoxy glue according to the manufacturer's instructions.



Apply the glue with the toothpick to the back of the magnet and stick it in the middle of a tile. Repeat with all the magnets and leave to dry for the required time. Make sure the glue has set before you use the magnets.



Tip

Seal your pictures front and back with modge podge before you stick them to the tiles. This will stop the resin or polymer coating discolouring the paper.





MAKE YOUR OWN JEWELLERY

Large, round pendants

These pendants were cast in chocolate moulds. We used pictures and lace and added decorations.

You will need

plastic or metal moulds (we used

plastic chocolate moulds)

✿ pictures and decorations of your choice

thongs, chains, ribbon or lace

metal rings or thin wire

✿ resin and hardener

✿ modge podge

✿ paintbrush

plastic measuring jug (you won't

be able to use it again)

plastic spoons

toothpicks

✿ Prestik or masking tape

rubber gloves

NOTE

- If the resin is milky before you mix in the hardener, heat it so it is completely clear. Place the jug containing the resin in a bowl and add hot water to the bowl to a level just above the resin. Mix until clear.
- Resin assumes the texture of the mould. If the mould is not smooth, the resin won't be smooth either. However, you can file, drill or polish the resin afterwards, provided you have the right tools for the job.

To make

- 1 Paint an even, thin coat of modge podge over your pictures. Leave to dry before repeating on the back of the pictures. Apply one or two more coats of modge podge to seal the pictures completely.
- 2 Cut the pictures to fit the moulds exactly and place a picture in each mould. Add the decorations on top of the pictures, if you are using them.
- 3 Put on a pair of protective rubber gloves, follow the manufacturer's instructions and pour the resin and then the hardener into the plastic measuring jug (we used 100g Pac-Chem Pacote 600 resin and 50g HY 2963 hardener. Mix enough for all your pendants). Mix



thoroughly but carefully with a plastic spoon, taking care not to let air bubbles form in the mixture.

4 Pour the mixture into the moulds. Press the decorations into place with a toothpick if they have moved and make sure that no air bubbles have formed. If air bubbles form, prick each one with a toothpick.

TIP You can pour a layer of resin into the mould first, before adding the pictures and decorations.

5 Insert the ring before the resin sets completely. Secure with Prestik or masking tape over the edge of the mould so it does not sink into the resin. You can also twist a short length of wire into the shape of a hook and insert that into the resin, if you prefer.

6 Leave to stand for at least 24 hours to set, then turn out the moulds. Neaten the edges of the resin with a craft knife. Thread a length of thong, chain, ribbon or lace through the ring to complete.

Variation

Purchase metal decorations from a bead shop and fill them with resin and decorations to make beautiful jewellery.

You will need

blank metal shapes

basic ingredients as for the pendants

baking tray, wax paper

To make

- 1 Seal and cut out the pictures, as for the round pendants.
- 2 Paint a coat of modge podge on the back of each picture and press into the mould to secure, then paint with more modge podge and leave it to dry.
- 3 Line the baking tray with a sheet of wax paper and arrange the blank metal decorations on the wax paper, ensuring that each one is completely level.
- 4 Mix the resin and hardener according to the manufacturer's instructions, pour into the moulds and leave to dry.
- 5 To make the domed shape on top, pour on another few layers of the resin-and-hardener mixture. This will warp the edges of the picture and will create an interesting effect. Pour the resin drop by drop so the mixture does not run over the edges of the metal shapes and spoil the effect. Leave to stand for at least 24 hours to allow the resin to harden.

LETTER COASTERS WITH A RESIN LAYER

You will need

- ✿ Supawood coasters
- ✿ pictures of your choice
- ✿ white craft or PVA paint
- ✿ modge podge
- ✿ craft paintbrush
- ✿ thin sheets of cork
- ✿ resin
- ✿ tongue depressors
- ✿ contact glue
- ✿ craft knife and cutting mat

To make

1 We bought a set of undecorated Supawood coasters measuring 10 x 10cm each. You could also have your own cut to size. Round the corners and paint the top and sides of each coaster white.

2 Cut out all your pictures so that they protrude 5mm over the edges of your coasters.

3 Paint each coaster with a coat of modge podge. Place a picture on the modge podge while it's still wet and smooth out neatly, then set aside and leave to dry completely. Paint each coaster with more modge podge. Trim the edges of each picture neatly and seal with a final coat of modge podge.

4 Once the coasters are ready and have dried completely, you can add the layer of resin. Place the coasters on a dropsheet or black refuse bag, which you can throw away once you're done. Mix the resin with a tongue depressor in a disposable cup.

TIP We used Pac-Chem Pacote 600 resin and HY 2963 hardener, but you could also use Pratley Kraftex Pratliglo.

5 Start by gradually pouring the resin into the centre of one coaster and use

a tongue depressor to spread it out all the way to the edges of the coaster. Be careful not to let it run over the edge of the coaster – rather pour too little the first time. Repeat to cover all the coasters with resin.

6 Leave the first layer of resin to harden overnight. Pour a second layer. Leave to harden completely.

TIP If small air bubbles form on the surface of the resin, use a straw and blow through it gently to release the

trapped air and remove the bubbles.

7 When the resin is completely hard, you can attach the cork sheeting. Cut the cork slightly larger than the coaster and apply contact glue, following the manufacturer's instructions. Neatly trim the edges with a craft knife. You can also sand the edges very lightly, if necessary.

TIP Leave the resin to harden for a few days before you start using your coasters.



MOULDED RESIN COASTERS

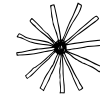

Good idea

We used dried flowers, rose petals, reeds, skeleton leaves, moss and cinnamon sticks for our coasters, but you can use anything that will suit your décor. Cake decorations or small plastic toys also work well.

To make

1 Decide on your decorations and arrange them in your moulds. The pieces must not stand higher than 8-10mm.

2 Put on your rubber gloves, follow the manufacturer's instructions and place the resin and then the hardener into the measuring jug on the scale (we used 500g Pacote 600 resin and 250g HY 2963 hardener, but you could also use Pratley Kraftex Pratligno). Mix with a plastic spoon for about three minutes or until the two components are thoroughly mixed together. Be careful to avoid mixing in any air bubbles.

NOTE If the resin has a milky appearance before you add the hardener, you will first need to heat it slightly to make it clear. Place the resin in the measuring jug then place the jug in a container. Add hot water to the container to just above the level of the resin. Mix the resin lightly until it becomes clear.

3 Pour the resin mixture into the moulds – remember, it will shrink slightly as it dries. Use toothpicks to reposition the decorations if they move out of place.

4 Leave for 24 hours to harden then remove from the moulds. They should come out easily. If the tops are uneven, you can level them with a little more resin. You should not have to place them back in the moulds. Simply mix and pour on a little resin and leave to stand for another 24 hours.

5 Stick the rubber feet onto the bottom corners of each coaster once the resin has set properly.

Working with resin

If you learn the basics of working with resin, there's no end to the things you can make for your house. These coasters with their organic decorations are a simple project to start with.

There are basically three main types of resin: epoxy, vinyl ester and polyester. For this project we used the epoxy type because it does not yellow, won't damage the organic components and is very strong.

You will need

- 🌸 resin and hardener
- plastic or metal moulds (we used 9 x 9cm plastic containers)
- decorations
- small, round self-adhesive rubber feet
- electronic scale
- plastic measuring jug (you will not be able to use it again)
- plastic spoons
- toothpicks
- rubber gloves

AIR - DRY CLAY

THIS IS A VERY EASY WAY TO CREATE DECORATIVE
ITEMS WITH THE MOST INTERESTING TEXTURES AND SHAPES.

You will need

- ✿ air-dry clay
- item with interesting texture, such as a crocheted doily, piece of lace or plate with a relief pattern
- rolling pin





We made this plate by pressing rolled-out air-dry clay onto a plate with a relief pattern on the underside. **NOTE** Plates and bowls made from air-dry clay are pretty, but they are for display purposes only. You can't use them for food as they will disintegrate when you wash them.

BOWL WITH A DOILY PATTERN

You will need

- air-dry clay
- old crocheted doily
- bowl to use as a mould
- rolling pin
- knife



1 Place a piece of clay on a smooth surface and roll it out with the rolling pin.



2 Roll the clay to about 3mm thick and large enough to fit over your bowl.



3 Place the doily on the rolled-out clay and roll over it again with the rolling pin. Press heavily enough to transfer the doily pattern into the clay.



4 First lift up one part of the doily to check that the pattern is clear enough, then lift off the whole doily.



5 Turn the bowl upside down and place it onto the clay. Cut away the excess clay with a knife. Pick up the bowl and turn it over.



6 Lightly press the clay into the bowl so that it takes on the shape. Leave it in the bowl until it is completely dry.

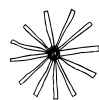

Good ideas

- When the clay bowl is completely dry, you can spray paint it in the colour of your choice or decorate it with metal leaf.
- Use the same idea to make gift tags and name cards, and even Christmas decorations. Cut out the shapes with cookie cutters.



CLAY ROSES

With these clay roses, an ordinary shop-bought vase can be transformed into a work of art.



You will need

vase or other item to be decorated

✿ air-dry clay

rolling pin

✿ strong glue

clay knife or paring knife



1 Roll out a piece of air-dry clay to approximately 3-4mm thick.



2 Cut out a strip of clay that narrows to a point at one end and is slightly rounded at the other. Make the strip wide enough so you have a piece at the bottom that you can hold onto as you work.

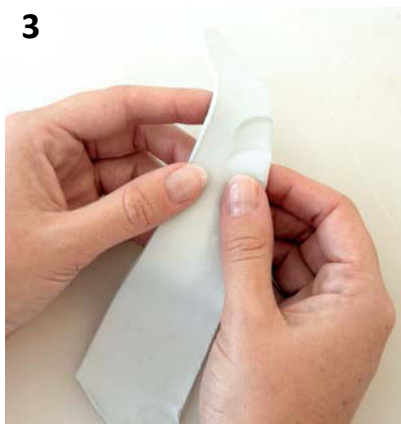

3 Flatten the long top edge of the clay strip with your finger – this is so that you can curl the rose petals later.

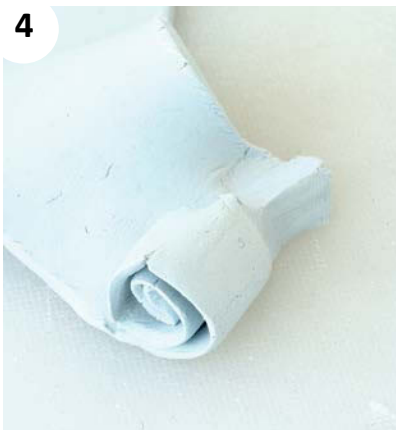

4 Begin at the narrow point and roll up the clay strip to form your rose.



5 When you are happy with the size, cut away the surplus clay on the side.



6 Pull open the outer 'petals' evenly and curl back the edges gently, using your fingers.

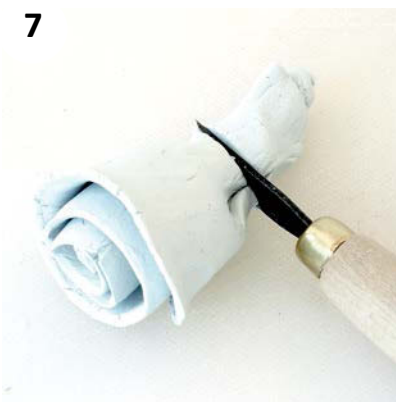

7 Cut away the excess clay at the base. Make more roses and stick them onto the vase with strong glue (we used Pattex No More Nails). Leave to dry.



Good idea

If you want the roses and vase to be the same colour, you can spray paint them. Glue the roses on the vase and leave the clay and the glue to dry properly before you spray paint lightly in the colour of your choice. Leave to dry and spray on more coats as necessary until you have a solid colour.

STRING

ART

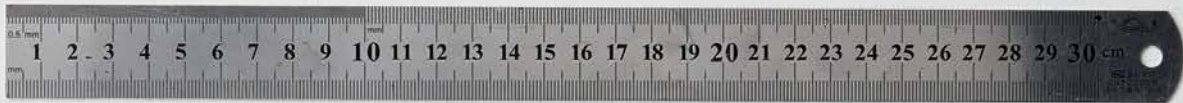

IF YOU DON'T MIND A LITTLE EFFORT AND A BIT OF NOISE,
THEN STRING ART IS A GREAT WAY TO MAKE
MODERN 'ARTWORKS' FOR YOUR HOME.

You will need

design of your choice

Supawood, or pine or plywood

panel pins or small nails

embroidery thread or crochet yarn in

the colour of your choice

✿ PVA paint OR

✿ craft paint

✿ sponge roller

✿ repositionable spray glue

✿ superglue

hammer and pliers



Basic technique

Whatever the difficulty level of your project, follow these basic steps.

To make

- 1 Choose your design and have the wooden board cut accordingly. Paint the board with two coats of PVA paint in the colour of your choice.
- 2 Photocopy your design in the size you prefer and make small dots spaced evenly apart all around the outline.
- 3 Spray glue on the back of the paper and stick it in position on the board.
- 4 Hammer in a panel pin on each of the marked dots – use a small piece of wood as a guide to make sure all the pins are at the same height. You can straighten out any skew pins with a pair of pliers. Remove the paper carefully when you are finished.
- 5 Make a tight double knot around the first panel pin and wrap the thread crisscross around the pins, or in any way that looks good to you. Continue in this way until the whole design is complete. Try to use each pin two or three times so that the thread is a similar thickness all around.
- 6 End with a double knot. Cut off the ends and strengthen the knot with a small drop of superglue.

EIFFEL TOWER

Here the secret lies in hammering in the pins very precisely according to the design. Keep the paper template in place under your pins while you are wrapping the strings and tear the paper off piece by piece as you go along to avoid getting confused. For a three-dimensional effect, wrap the thread a couple of times over the same pins.

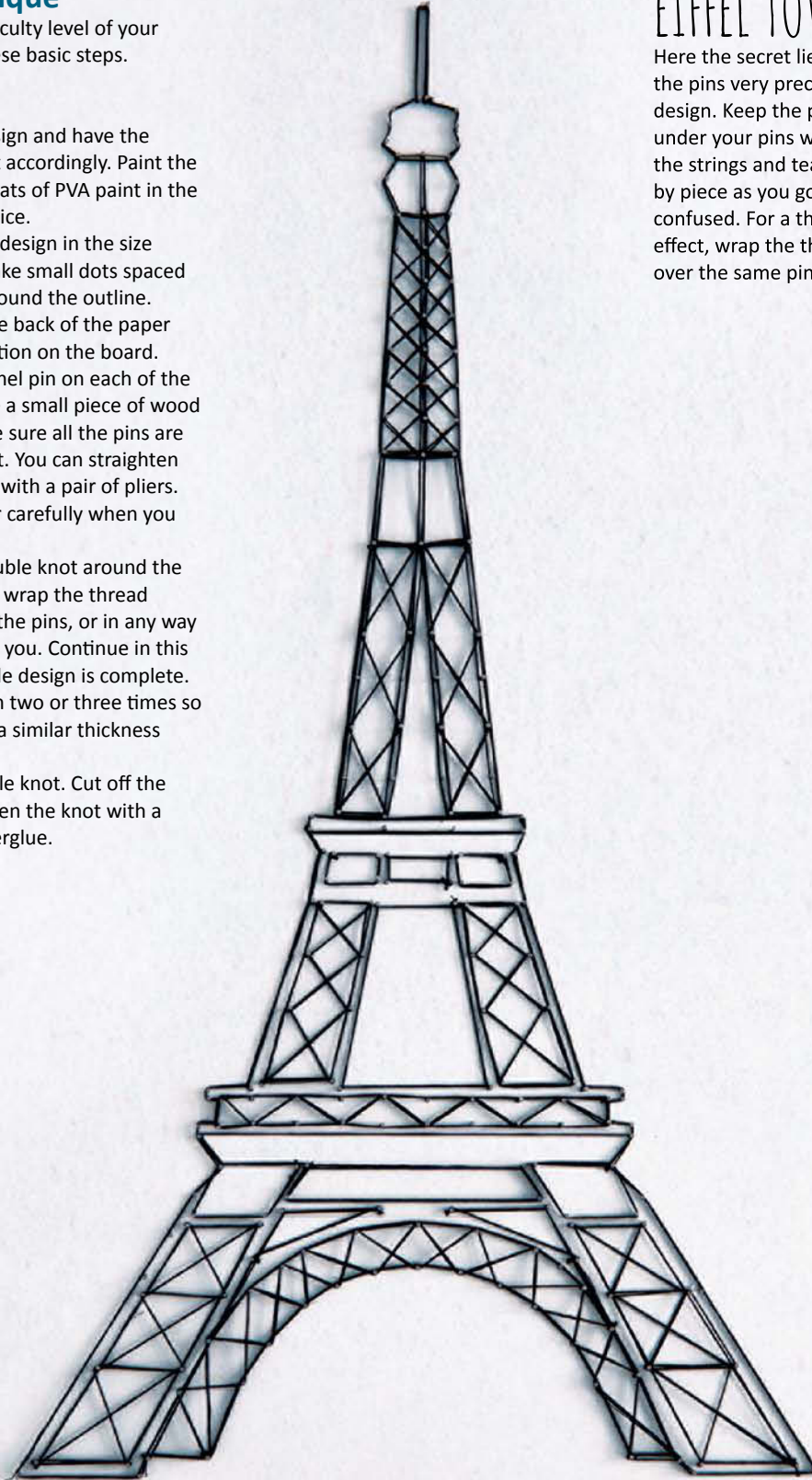

You will need

- bicycle picture with clear details
- wooden board (plywood or pine)
- embroidery thread in the colour of your choice
- small panel pins
- sponge roller
- PVA paint in a colour of your choice OR craft paint
- repositionable spray glue
- hammer and pliers
- marking pen

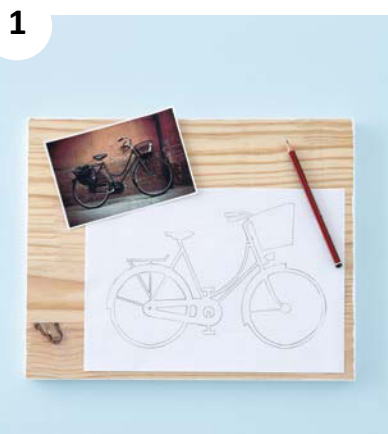

Copy your bicycle design in the desired size. We traced ours from a photograph.



Paint the wooden board first, if you prefer. We painted ours white for a contrast with the dark thread. While you wait for the paint to dry you can plan where you are going to hammer the panel pins into the picture – we marked the dots with a marking pen. Remember to leave enough space between the dots so it is easy to hammer in the panel pins.

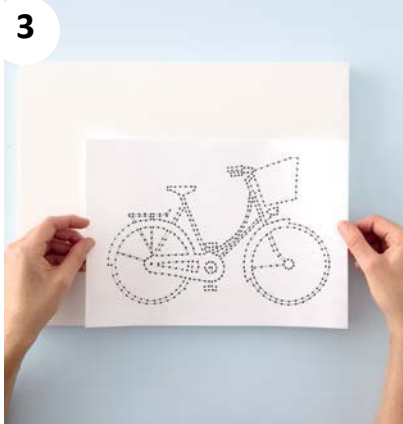

Spray glue onto the back of the template and stick it in position on your wooden board.

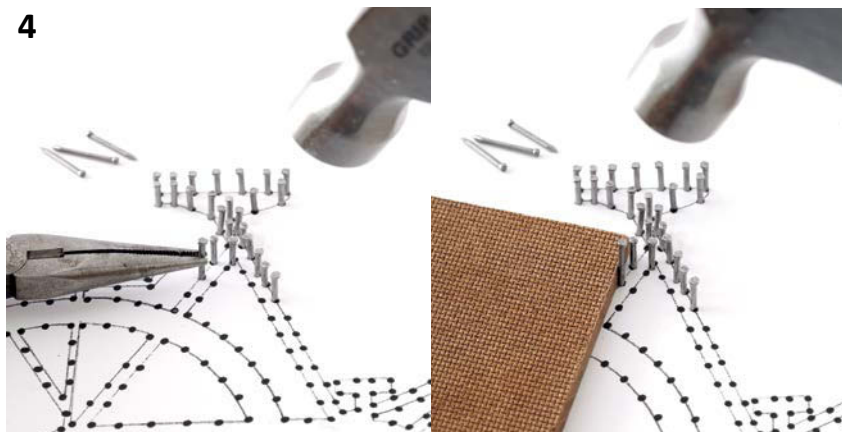

Now hammer in a panel pin at each marked dot. You can grip the pins with pliers if you struggle to hold them in your fingers. Hammer in the pins to more or less the same depth. You can use a small piece of wood or board as a guide. Straighten any skew pins with the pliers or tap them straight with your hammer.

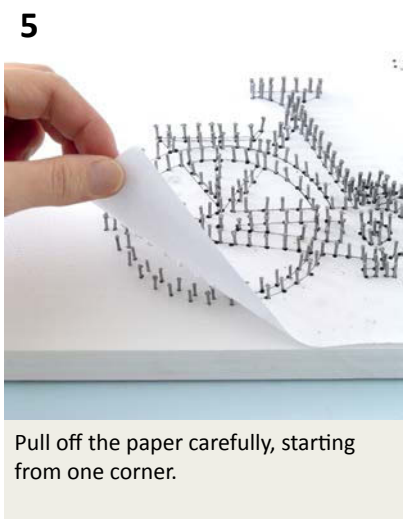

Pull off the paper carefully, starting from one corner.



Choose a starting point and make a secure double knot around the first pin. Turn the string around the head of the next pin and then the next one. Continue in this way until the bicycle design is complete. Try not to turn the string more than two or three times around the same panel pin – it will make the threads too thick – and fill in the gaps as you go.

A BICYCLE FOR YOUR WALL

String art was very popular in the 1960s and 70s, and now, thanks to the current embroidery and crochet revival, it has also had a new lease of life. We show you how to make this bicycle with string and nails.



TIP

There are no rules as to how many dots you should make and how far apart to make them, but remember that you will need more pins around the curves to be able to shape them nicely. There must also be enough pins to work all the detail.

PAPER

HANDMADE PAPER IS LOVELY AND ADDS A SPECIAL TOUCH TO WHATEVER YOU USE IT FOR. BY MAKING YOUR OWN PAPER YOU'LL ALSO BE CONTRIBUTING TO RECYCLING. YOU CAN BE CREATIVE WITH DIFFERENT TYPES OF PAPER AND EVEN ADD SEEDS OR DRIED FLOWERS.

You will need

FOR THE PAPER

- 🌸 white computer paper (use recycled paper where possible)
- water

FOR THE SCREEN

20 x 20mm pine:

- four 330mm pieces (sides)
- four 210mm pieces (top, bottom)

net curtain

- 🌸 wood glue

staple gun

8 L-shaped metal plates with screws

electric screwdriver

Basic method

Regardless of the scale on which you're making paper, the basic method and processes remain the same. You soak the paper in water then separate the solids from the liquid through a mould screen, known as a deckle. The fibres that remain behind are then used to make your new sheet of paper. You can use paper or plant fibres. The latter are tricky to work with and need lots of preparation, so we chose to work with recycled paper. Regular white paper is the best choice. Brown paper and newsprint also work well, but yield a duller, weaker paper.

Deckle

A deckle is a paper mould screen that consists of a double frame that has stretched net curtain on one of the frames. The net catches the paper pulp. The size of the deckle determines the size of your paper. You can buy a ready-made deckle, if you prefer, but it's quite simple and cost-effective to make your own. Ours is suitable for making A4-sized paper.

To make

- 1 Make the frame for your deckle. Fit two 210mm pieces of 20 x 20mm pine inside two 330mm pieces and glue them together. Screw an L-shaped metal plate to each corner, then wipe away any excess glue with a damp cloth.
- 2 Place the frame on the net curtain with the metal plates facing up. Leave an allowance of 60mm right round, then cut the netting to size.
- 3 Fold the netting over one short side and secure with a staple in the centre. Carefully pull the net tight and staple onto the opposite short side. Repeat to attach it to the long sides of your frame. Keep inserting staples in this crisscross manner until you've secured it right round, then trim the netting neatly.
- 4 Repeat steps 1 and 2 to make the second frame of your deckle, this time without a net curtain.

HANDMADE PAPER



You will need

- ✿ white computer paper, torn into pieces or shredded
-
- deckle
-
- ✿ rubber linoleum (same size, to fit inside of deckle)
-
- felt on which to dry the paper (slightly larger than your finished sheets of paper)
-
- absorbent kitchen cloths (or more felt, or paper towels)
-
- plastic container for each colour paper you'll be making (the deckle must fit inside)
-
- stick blender
-
- rolling pin

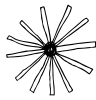

Tips

- Set aside any excess pulp, to use to even out the thickness of your paper.
- Colour the pulp with food colouring.
- Make fragrant paper by adding one or two drops of essential oil to the pulp.
- Mix short strips of embroidery or machine thread into the pulp.
- Add glitter, dried flowers, petals, seeds or leaves to the pulp bath.
- For spotted paper, make a fine pulp of small pieces of the same colour paper. Add larger pieces of another colour and pulp for a few seconds with a stick blender, to form colour spots.
- Place cookie cutters on your deckle and pour pulp into them to make paper in various shapes. Use them as name cards or gift tags.

1



Soak the paper pieces overnight, or preferably for 24 hours, in a bowl with lots of water.

NOTE Keep the different types and colours of paper separated for now. You can always mix them later, if you see that they go well together.

2



Remove the soaked paper from the water and discard the water. Place the soaked paper back into the bowl. Add three parts clean water to each part of paper, then pulp the paper using a stick blender.

3



Pour the pulp into a plastic container, first making sure your deckle will fit into the container. Add more water, but take care not to add too much – you can always add more later if the pulp is too thick. You can also remove some of the pulp (see the tip with step 5). Mix well.

4



Turn the netting frame so the net faces upwards. Place the other frame on top with the metal plates facing you. Press together firmly, then insert into the pulp bath, working gradually from one side of the container. Hold the deckle down for a few moments.



Lift up the two frames together so the paper fibres are scooped up and deposited on the netting. Now lift the frames out of the water completely, first letting the excess water drip off. If the pulp layer is too thick or too thin for the paper you want to make, or isn't even, repeat the process until you're happy with the coverage. **TIP** If you've scooped up too much pulp the first time round, you can scrape some of it off and set it aside. The second time, or with a bit of practice, you should be able to scoop up the right amount of pulp.



Place the deckle at an angle over the container to drain. Place a sheet of linoleum over the pulp and press down to help the draining process. Remove the top frame.

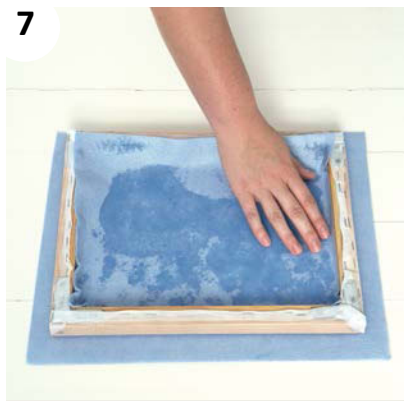

Turn the netting frame over onto a piece of felt so the linoleum is facing downwards. Use kitchen towels to squeeze out as much of the remaining water as you can.

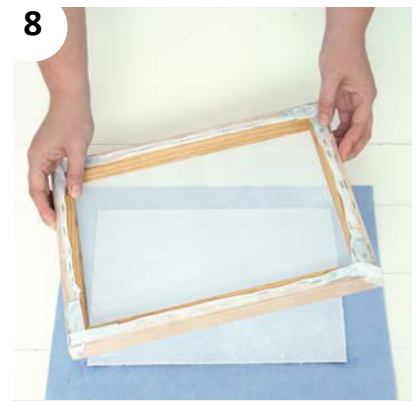

Carefully lift the frame off the paper, starting in one corner. The drier the paper, the easier it will be to lift off the frame.



Place a clean, dry, absorbent cloth over the paper while it is still lying on the linoleum, then use a rolling pin to squeeze out more of the water.

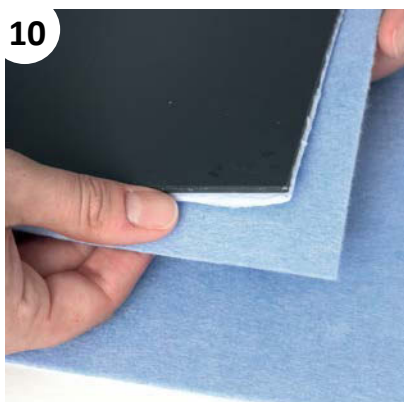

Carefully turn over the linoleum with the cloth still in place. Loosen the paper that has curled around the edges by gently pressing down with your thumbs.



Use a slow, rolling motion to remove the linoleum from the paper. Leave the paper on the cloth to dry.

PAPER PRESS



With this paper press you will be able to dry several layers of paper, and also produce smoother paper.

You will need

two 380 x 290 x 9mm marine ply planks

4 long bolts

4 wingnuts

4 washers

4 nuts

drill with wood drill bits

absorbent kitchen towels or felt

To make

- 1 Drill the holes for the bolts at the corners of the two planks, making them slightly larger than the bolts. We used 6mm bolts and an 8mm drill bit.
TIP Clamp the two planks together so you can drill the holes in one go. Mark the corners beforehand to make it easier to see which ones correspond.
- 2 Insert the bolts from the bottom of one plank and secure with the nuts.
- 3 Place two or three layers of absorbent cloth on the plank. Layer the wet sheets of paper on top of the cloth, with more cloths in between and also on top of the last sheet of paper.
- 4 Place the other plank on top. Add a washer to each bolt and secure with the wingnuts.
- 5 Replace the cloths with clean, dry cloths every day until the paper has dried out completely. This could take two to three days.

ROSE-PETAL PAPER

Add dried rose petals to the soaked paper shreds before pulping everything together with a stick blender. You can also add some food colouring.



PAPER THAT GROWS

Paper containing seeds can be planted after use so they can grow. We used thyme, but any small, round herb seeds, such as basil or rocket, will work. Sprinkle them over the pulp in your deckle, just before you press out the water (step 6). Follow the remaining steps and leave to dry. You can use this paper for greeting cards, gift cards or invitations. Tell the recipient to plant it directly in the ground. If it's kept moist, it will germinate and grow.





Learning is a treasure
that will **follow** its owner
everywhere!



EDUCATIONAL BOOKS



Colour your World...

**Education is the most powerful weapon
we can use to change the world.**
~Nelson Mandela~

Today is a great day to learn something
new, and there's no better way to
stimulate your mind and refresh your
knowledge than with **PNA's collection of
Educational Books.**

Pop in to your local **PNA store** for the
latest **Educational Books** and
Study Guides, certain to
provide all the academic assistance
you may require.



www.pna.co.za

Stationery | Art & Craft Materials | Educational Books | Gifts



SCREEN

SCREEN PRINTING

ONCE YOU KNOW HOW TO DO SCREEN PRINTING, YOU CAN DECORATE ALL THE FABRIC IN YOUR HOME WITH YOUR OWN DESIGNS.

Screen frame

You can buy ready-made screens, but it is very easy to make one yourself. Remember, the larger the frame, the larger the designs that you will be able to print. You can use the same frame over and over again.

You will need

four 22 x 44mm pine planks in the
desired length for the frame

piece of voile or organza fabric that
fits over the frame

eight 8 x 50mm chipboard screws

drill with 3mm and 8mm drill bits

staple gun and staples

✿ water-resistant paint or wood glue

✿ flat paintbrush

How to make a screen frame

1 Decide on the size of the frame you would like to make and have the 44mm pine planks cut to size. Mark where the planks will be screwed together – two screws per side – and drill and countersink the holes, then insert the screws.

2 Cut a piece of voile or organza to cover the screen, allowing extra right around so you can fold the fabric over the frame. Pull the fabric tight and staple to secure, working your way to the corners from the centre of each plank. The fabric must be tight across the entire frame.

3 Paint a thin coat of water-resistant paint or wood glue all along the front of the frame section to seal it. Leave to dry completely.



PRINTED TABLE RUNNER

You will need

- screen frame
- fabric that you want to screen
- print, washed for shrinkage
- frame template on page 90,
or use your own design
- red stencil film
- water-based screen-printing
paint
- thinners
- ☼ squeegee, preferably slightly
wider than the design
- ☼ masking tape
- ☼ craft knife and cutting mat
- ☼ metal ruler
- soft, clean cloth



1



Copy your design in the desired size. Stick it to your cutting mat with masking tape then stick the stencil film on top, with the dull red side facing upwards.

2



Cut out the design using your craft knife. Press lightly to avoid cutting through the bottom acetate layer. Peel off the red sections from the acetate layer as you work.

3



Pack old magazines on your work surface with some newspaper on top. Place your stencil, dull red side facing upwards, on it, followed by the screen frame with the screen against the stencil. Put thinners on a cloth and rub all over the stencil so the red layer begins to dissolve and colour the fabric. Blot often with another cloth so that the red doesn't bleed into the open parts of the stencil. Continue until the entire stencil adheres to the screen. Leave to dry.

4



Turn the frame over and remove the acetate layer carefully from the screen. If it still feels tacky on the bottom, it is not properly dry yet.

5



Stick masking tape around the stencil so the paint can't seep through. Place the frame with the screen side facing downwards onto the fabric you want to print on.

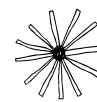

Tip

Colour the sections of the design that you want to cut out – in other words, the sections where the paint will go through – black to make the cutting out easier.

6



Scoop paint onto the stencil, enough to cover the whole design. Ask someone to hold the frame while you work, or stick the sides to the fabric with masking tape.

7



Hold your squeegee at a 45-degree angle behind the paint and then draw it over the stencil, applying even pressure. Repeat this if necessary.

8



Lift the frame up and print the next piece of fabric. You can continue working as long as the paint on the screen is still wet. When you're finished, scrape the paint from the screen and rinse it with water or wash it with the garden hose. Leave to dry completely before storing it.

Remember

- The tools and equipment that you need to buy to do screen printing are relatively costly. However, it is advisable to invest in good-quality screens to ensure printing of a high standard. When you use the photographic method, in particular, you can expect bright colours, sharp lines and fine detail.
- You can reuse your screen many times if you use it correctly and clean it thoroughly every time. You can make quite a few prints before you need to wash the screen.
- It's quite a big job to wash and clean a screen. Ideally, you need a high-pressure nozzle and a stainless-steel basin in an outside area.

Tips for screen printing on fabric

- When printing on fabric, ensure that your work can't move around. Work on a wooden or melamine surface that is larger than the screen frame you're using. Apply a thin coat of stencil glue or another suitable adhesive over the work surface, then leave to dry or follow the manufacturer's instructions. Place the fabric on the work surface right side facing up. Smooth it out from the centre with the palms of your hands. Make sure the fabric is completely smooth – there must be no creases or bubbles.
- Remember, if you're working with a double layer of fabric – like a T-shirt or pillowcase – you'll need a board to slide between the two layers of fabric, to prevent the ink seeping through and spoiling the other side of the item. We used a plastic mat that we also painted with a thin coat of adhesive.

SCATTER CUSHIONS

Print a design on a plain scatter cushion. You can also print your designs layer on layer in different colours.



NAPKINS

Print your designs on napkins, as part of a set of matching table linen.



RIBBONS

Print your design on cotton ribbons and use them for gifts or for your business packaging.



PILLOWCASES

Print white pillowcases
– or even a complete
duvet set – with a variety
of matching designs.

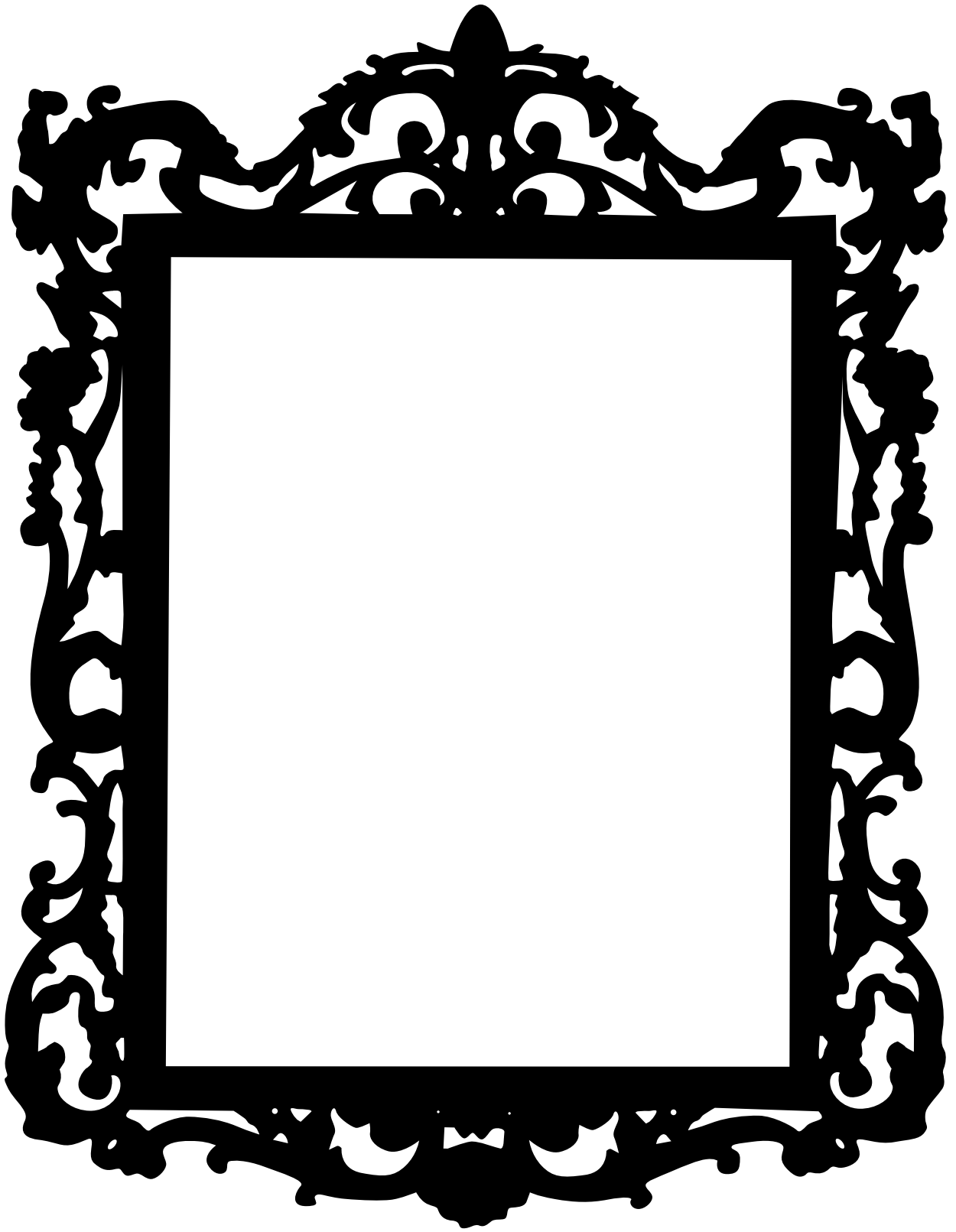

STAY CREATIVE

✦ All the ideas you will need to keep on crafting



Your monthly
ideas

... MAKE your world beautiful



SPONSORED BY



COLOUR YOUR WORLD...

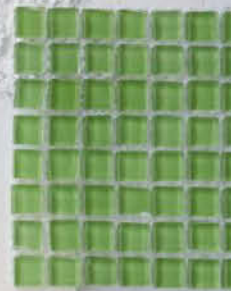

ALL YOUR CRAFT SUPPLIES IN ONE PLACE.
TO FIND YOUR NEAREST PNA, GO TO WWW.PNA.CO.ZA